



Boring tools & drilling tools



<p>CKB*-TWN</p>  <p>P207</p>	<p>CKB*-EWN</p>  <p>P208</p>	<p>BT*-CKB*-TWN</p>  <p>P209~P210</p>	<p>BT*-CKB*-EWN</p>  <p>P211~P212</p>
<p>RDH-D*-L</p>  <p>P213</p>	<p>CDH-D*-L</p>  <p>P213</p>	<p>BJ*BE*A</p>  <p>P214</p>	<p>CDH-D*-L</p>  <p>P214</p>
<p>WBJ**</p>  <p>P215</p>	<p>WBJ**</p>  <p>P2115</p>	<p>EC*/ST*/BE*</p>  <p>P216</p>	<p>NBH*</p>  <p>P217</p>
<p>SBJ**</p>  <p>P217</p>	<p>BT*-NBH*-P</p>  <p>P217</p>	<p>SC*-CKB*-L</p>  <p>P218</p>	<p>BT*-CKB*</p>  <p>P219</p>
<p>Extension</p>  <p>P220</p>	<p>Extension</p>  <p>P220</p>	<p>BT*-DW*</p>  <p>P221</p>	<p>SPMG2D/3D/4D</p>  <p>P223~P225</p>
<p>WCMX2D/3D/4D</p>  <p>P226~P228</p>	<p>SPMG**</p>  <p>P229</p>	<p>WCMX-S</p>  <p>P229</p>	<p>Eccentric Sleeve</p>  <p>P230</p>

Turning inserts

External turning

Internal turning

Grooving & parting

Threading

Milling

Boring & drilling

Tool holder

Solid carbide end mills

Solid carbide drill & taps

Technical information

Turning inserts

External turning

Internal turning

Grooving & parting

Threading

Milling

Boring & drilling

Tool holder

Solid carbide end mills

Solid carbide drill & taps

Technical information

Two-Blade Rough Boring Head

《Boring Range form $\Phi 25 - \Phi 204\text{mm}$ 》

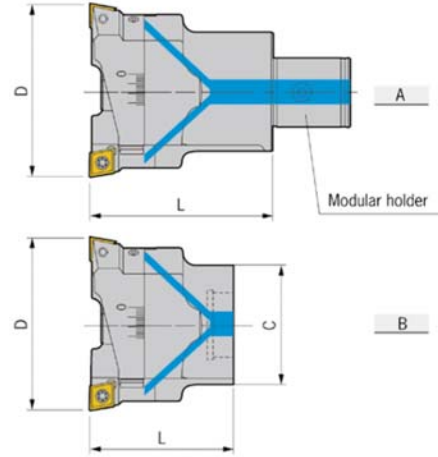

Ordering Code	Stock	D	C	L	Insert	Screw	Wrench	Cutter block	Clamp screw	Weight
CKB1-TWN2031-35	●	20-26	19	35	CC..0602..	M2.5X6.5	T7	TW20-26M	TW20TS	0.07
	●	25-31	19	35	CC..0602..	M2.5X6.5	T7	TW25-31M	TW20TS	0.12
CKB2-TWN3038-38	●	30-38	24	38	CC..0602..	M2.5X6.5	T7	TW30-38M	TW25TS	0.14
CBK3-TWN3747-43	●	37-47	31	43	CC..09T3..	M4X10	T15	TW37-47M	TW30TS	0.23
CBK4-TWN4659-50	●	46-59	39	50	CC..09T3..	M4X10	T15	TW46-47M	TW40TS	0.43
CBK5-TWN5875-60	●	58-75	50	60	CC..1204..	M5X13	T20	TW58-75M	TW50TS	0.82
CBK6-TWN7496-75	●	74-96	64	75	CC..1204..	M5X13	T20	TW74-96M	TW50TS	1.75
CKB6-TWN95122-75	●	95-122	64	75	CC..1204..	M5X13	T20	TW95-122M	TW50TS	2.35

Features:

1. Thickened cartridge with higher rigidity;
2. Coolant nozzle easily cools the insert elongating its working life;
3. Comlpted with chip pocket, improving chipflow of deep boring;
4. Clamp plate solidifies cartridges and head, upgrading cutting rigidity.
5. Patented step boring design, suitable for both level boring and step boring.

● Stock ○ Available upon Order

EWN Micro-Finishing Boring Head

《Boring Range form $\Phi 25$ – $\Phi 204$ mm》

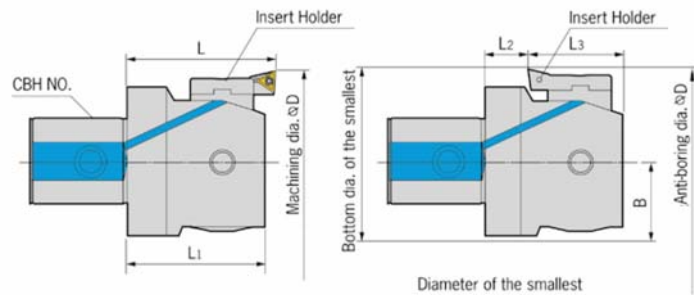

Ordering Code	Stock	dm	L	DC	Cutter block	Insert	Screw	Wrench	Weight
CKB1-EWN2031-32	●	19	32.5	20-26	ENH1-1	TP..0802	M2*5	T7	0.09
				25-31	ENH1-2				
CKB1-EWN2540-35	●	24	35.5	25-33	ENH1-1	TP..0902	M2.5*6	T8	0.13
				32-40	ENH1-2				
CKB2-EWN3045-35	●	31	40	30-38	ENH2-1	TP..0802	M2*5	T7	0.15
				37-45	ENH2-2				
CKB2-EWN3756-40	●	39	47	37-47	ENH3-1	TP..0802	M2*5	T7	0.25
				46-56	ENH3-2				
CKB4-EWN4671-47	●	50	57	46-59	ENH4-1	TP..1103	M3*8	T10	0.43
				58-71	ENH4-2				
CKB5-EWN5890-57	●	64	71	58-75	ENH5-1	TP..1103	M3*8	T10	1.25
				73-90	ENH5-2				
CKB16-EWN73130-71	●	75-96	98-130	75-96	ENH6-1	TP..1103	M3*8	T10	1.78
				98-130	ENH6-2				

1. There are pre-balanced design, availability and stability of the machining accuracy.
2. Standard corresponding to the anti-boring work processing, using a wide range of increasing added value.

PAT.P	Tape	Stock	Fig	Boring head	Tape	Fig	Boring head
	ENH1-1	●	TP08	EWN20-31	ENH4-1	TC11 TP11	EWN46-71
ENH1-2	●	ENH4-2					
ENH2-1	●	EWN30-45	ENH5-1	EWN58-90			
ENH2-2	●		ENH5-2				
ENH3-1	●	EWN37-56	ENH6-1	EWN73-130			
ENH3-2	●		ENH6-2				

● Stock ○ Available upon Order

Turning inserts

External turning

Internal turning

Grooving & parting

Threading

Milling

Boring & drilling

Tool holder

Solid carbide end mills

Solid carbide drill & taps

Technical information

TWN Rough Boring Head

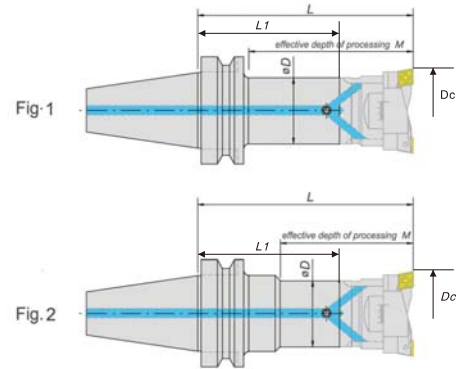

Ordering Code	Stock	Dc	YKL+TWN		PM	D	L	L1	Weight
BT30-CKB1TWN2026-81	●	20-26	BT30-CKB1-80	CKB1-TWN2026-35	81	19	115	80	0.48
BT30-CKB1TWN2531-81	●	25-31		CKB1-TWN2531-35	81	19	115	80	0.48
BT30-CKB2TWN3038-81	●	30-38	BT30-CKB2-80	CKB2-TWN3038-38	81	24	118	80	0.51
BT30-CKB3TWN3747-96	●	37-47	BT30-CKB3-80	CKB3-TWN3747-43	96	31	123	80	0.70
BT30-CKB4TWN4659-101	●	46-59	BT30-CKB4-80	CKB4-TWN4659-50	101	39	130	80	0.91
BT40-CKB1TWN2026-84	●	20-26	BT40-CKB1-85	CKB1-TWN2026-35	84	19	120	85	1.12
BT40-CKB1TWN2531-84	●	25-31		CKB1-TWN2531-35	84	19	120	85	1.15
BT40-CKB2TWN3038-87	●	30-38	BT40-CKB2-85	CKB2-TWN3038-38	87	24	123	85	1.21
BT40-CKB3TWN3747-111	●	37-47	BT40-CKB3-95	CKB3-TWN3747-43	111	31	138	95	1.32
BT40-CKB3TWN3747-123	●		BT40-CKB3-125		123	31	168	125	1.46
BT40-CKB4TWN4659-118	●	46-59	BT40-CKB4-95	CKB4-TWN4659-50	118	39	145	95	1.54
BT40-CKB4TWN4659-148	●		BT40-CKB4-125		148	39	170	125	1.86
BT40-CKB5TWN5875-128	●	58-75	BT40-CKB5-95	CKB5-TWN5875-60	128	50	155	95	1.81
BT40-CKB5TWN5875-158	●		BT40-CKB5-125		158	50	185	125	2.35
BT40-CKB6TWN7496-143	●	74-96	BT40-CKB6-95	CKB6-TWN7496-75	143	64	170	95	2.20
BT40-CKB6TWN7496-173	●		BT40-CKB6-125		173	64	200	125	3.05
BT40-CKB6TWN96122-143	●	96-122	BT40-CKB6-95	CKB6-TWN96122-75	143	64	170	95	2.20
BT40-CKB6TWN96122-173	●		BT40-CKB6-125		173	64	200	125	3.05

● Stock ○ Available upon Order

TWN Rough Boring Head

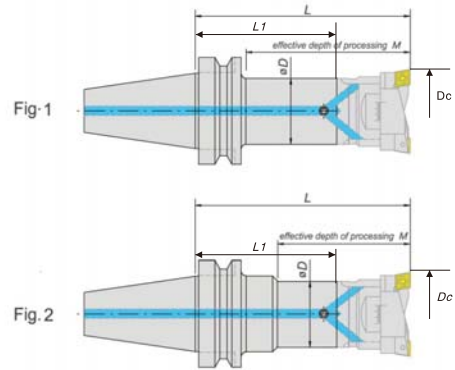

Ordering Code	Stock	Dc	YKL+TWN		PM	D	L	L1	Weight
BT50-CKB1TWN2026-102	●	20-26	BT50-CKB1-110	DKB31-TWN2026-35	102	19	145	110	3.92
BT50-CKB1TWN2531-102	●	25-31		DKB31-TWN2531-35	102	19	145	110	9.96
BT50-CKB2TWN3038-105	●	30-38	BT50-CKB2-110	DKB32-TWN3038-38	105	24	148	110	4.06
BT50-CKB3TWN3747-118	●	37-47	BT50-CKB3-125	DKB33-TWN3747-43	118	31	168	125	4.28
BT50-CKB3TWN3747-133	●		BT50-CKB3-165		133	31	208	165	4.39
BT50-CKB4TWN4659-132	●	46-59	BT50-CKB4-125	DKB34-TWN4659-50	132	39	175	125	4.61
BT50-CKB4TWN4659-145	●		BT50-CKB4-165		145	39	215	165	4.81
BT50-CKB5TWN5875-147	●	58-75	BT50-CKB5-125	DKB35-TWN5875-60	147	50	175	125	4.73
BT50-CKB5TWN5875-187	●		BT50-CKB5-165		187	50	225	165	5.17
BT50-CKB6TWN7496-162	●	74-96	BT50-CKB6-125	Cx36-TWN7496-75	162	64	200	125	5.26
BT50-CKB6TWN7496-202	●		BT50-CKB6-165		202	64	240	165	6.02
BT50-CKB6TWN7496-242	●		BT50-CKB6-205		242	64	280	205	6.78
BT50-CKB6TWN95122-162	●	75-122	BT50-CKB6-125	Cx36-TWN95122-75	162	64	200	125	5.26
BT50-CKB6TWN95122-202	●		BT50-CKB6-165		202	64	240	165	6.02
BT50-CKB6TWN95122-242	●		BT50-CKB6-205		242	64	280	205	6.78

● Stock ○ Available upon Order

Turning inserts

External turning

Internal turning

Grooving & parting

Threading

Milling

Boring & drilling

Tool holder

Solid carbide end mills

Solid carbide drill & taps

Technical information

EWN Micro-Finishing Boring Head

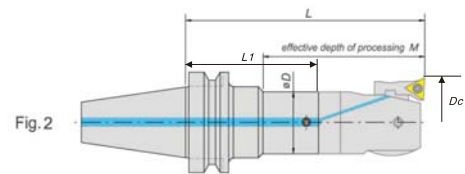
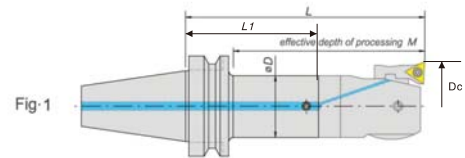

Ordering Code	Stock	Dc	CKB+EWN		M	D	L	L1	Weight
BT30-CKB1EWN2031-78	●	20-31	BT30-CKB1-80	CKB1-EWN2031-32.5	78	19	112.5	80	0.56
BT30-CKB1EWN2536-78	●	25-36		CKB1-EWN2536-32.5	78	19	112.5	80	0.56
BT30-CKB2EWN3045-81	●	30-45	BT30-CKB2-80	CKB2-EWN3045-35	81	24	115	80	0.60
BT30-CKB3EWN3756-98	●	37-56	BT30-CKB3-80	CKB3-EWN3756-40	98	31	120	80	0.76
BT30-CKB4EWN4671-105	●	46-71	BT30-CKB4-80	CKB4-EWN4671-47	105	39	127	80	1.05
BT40-CKB1EWN2031-82	●	20-31	BT40-CKB1-85	CKB1-EWN2031-32.5	82	19	117.5	85	1.19
BT40-CKB1EWN2536-82	●	25-36		CKB1-EWN2536-32.5	82	19	117.5	85	1.19
BT40-CKB2EWN3045-84	●	30-45	BT40-CKB2-85	CKB2-EWN3045-35	84	24	120	85	1.28
BT40-CKB3EWN3756-108	●	37-56	BT40-CKB3-95	CKB3-EWN3756-40	108	31	135	95	1.38
BT40-CKB3EWN3756-120	●		BT40-CKB3-125		120	31	155	125	1.51
BT40-CKB4EWN4671-115	●	46-71	BT40-CKB4-95	CKB4-EWN4671-47	115	39	142	95	1.62
BT40-CKB4EWN4671-145	●		BT40-CKB4-125		145	39	172	135	1.97
BT40-CKB5EWN5890-125	●	58-90	BT40-CKB5-95	CKB5-EWN5890-57	125	50	152	95	1.92
BT40-CKB5EWN5890-155	●		BT40-CKB5-125		155	50	182	135	2.48
BT40-CKB6EWN73130-147	●	73-130	BT40-CKB6-95	CKB6-EWN73130-71	147	64	166	95	2.32
BT40-CKB6EWN73130-177	●		BT40-CKB6-125		177	64	196	135	3.18

● Stock ○ Available upon Order

EWN Micro-Finishing Boring Bar

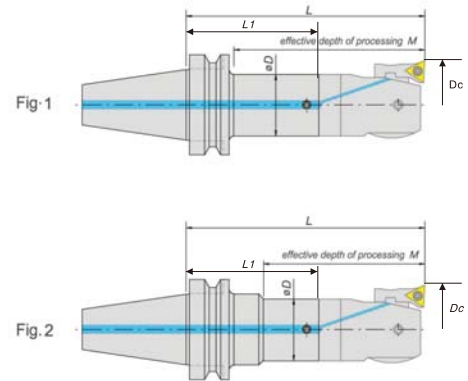

Ordering Code	Stock	Dc	CKB+EWN		PM	D	L	L1	Weight
BT50-CKB1EWN2031-100	●	20-31	BT50-CKB1-110	CKB1-EWN2031-32.5	100	19	142.5	110	4.05
BT50-CKB1EWN2536-100	●	25-36		CKB1-EWN2536-32.5	100	19	142.5	110	4.05
BT50-CKB2EWN3045-102	●	30-45	BT50-CKB2-110	CKB2-EWN3045-35.5	102	24	145.5	110	4.15
BT50-CKB3EWN3756-115	●	37-56	BT50-CKB3-125	CKB3-EWN3756-40	115	31	165	125	4.38
BT50-CKB3EWN3756-130	●		BT50-CKB3-165		130	31	205	165	4.50
BT50-CKB4EWN4671-129	●	46-71	BT50-CKB4-125	CKB4-EWN4671-47	129	39	172	125	4.75
BT50-CKB4EWN4671-144	●		BT50-CKB4-165		144	39	212	165	4.93
BT50-CKB5EWN5890-139	●	58-90	BT50-CKB5-125	CKB5-EWN5890-57	139	50	182	125	4.85
BT50-CKB5EWN5890-154	●		BT50-CKB5-165		154	50	222	165	5.27
BT50-CKB6EWN73130-158	●	73-130	BT50-CKB6-125	CKB6-EWN73130-71	158	64	196	125	5.35
BT50-CKB6EWN73130-198	●		BT50-CKB6-165		198	64	236	165	6.21
BT50-CKB6EWN73130-238	●		BT50-CKB6-205		238	64	276	205	6.91

● Stock ○ Available upon Order

Turning inserts

External turning

Internal turning

Grooving & parting

Threading

Milling

Boring & drilling

Tool holder

Solid carbide end mills

Solid carbide drill & taps

Technical information

Turning inserts

External turning

Internal turning

Grooving & parting

Threading

Milling

Boring & drilling

Tool holder

Solid carbide end mills

Solid carbide drill & taps

Technical information

Indexable Two-blade Rough Boring Head

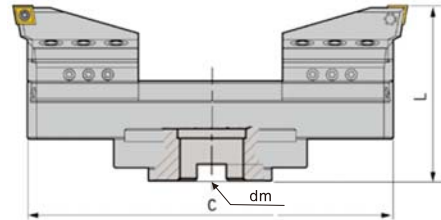

Ordering Code	Stock	dm	L	C	Insert	Cutter block	Extension Side	Clamp	Screw	Screw	Wrench	Weight
RDH-D122-152-80L	●	32	84	122-152	CC..1204	RDH-CC12	HB122-152	RDH-HK	NLJ-M8	M5*13	T20	3
RDH-D151-211-80L	●			151-211			HB151-211					5
RDH-D210-290-80L	●			210-290			HB210-290					5.9
RDH-D290-370-80L	●			290-370			HB290-370					6.8
RDH-D370-450-80L	●			370-450			HB370-450					7.8
RDH-D450-550-80L	●			450-550			HB450-550					8.8
RDH-D550-650-80L	○			550-650			HB550-650					9.9
RDH-D650-750-80L	○			650-750			HB650-750					10.9

Indexable Two-blade Rough Boring Head

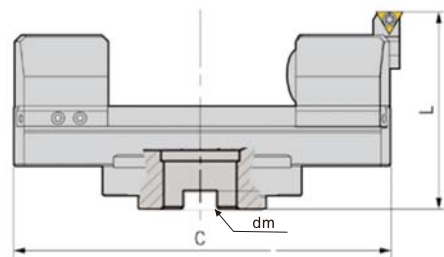

Ordering Code	Stock	dm	L	C	Insert	Boring	Clump weight	Extension Side	Screw	Screw	Wrench	Weight
CDH-D122-152-84L	●	32	84	122-152	TP..0902	CDH-TT	CDH-PHK	HB122-152	NLJ-M8	M5*13	T20	3
CDH-D151-211-84L	●			151-211				HB151-211				4.8
CDH-D210-290-84L	●			210-290				HB210-290				5.2
CDH-D290-370-84L	●			290-370				HB290-370				6.1
CDH-D370-450-84L	●			370-450				HB370-450				7
CDH-D450-550-84L	●			450-550				HB450-550				8
CDH-D550-650-84L	●			550-650				HB550-650				9
CDH-D650-750-84L	●			650-750				HB650-750				10

● Stock ○ Available upon Order

Outside diameter boring series

S type Processing range: $\Phi 0.5 \sim \Phi 27$

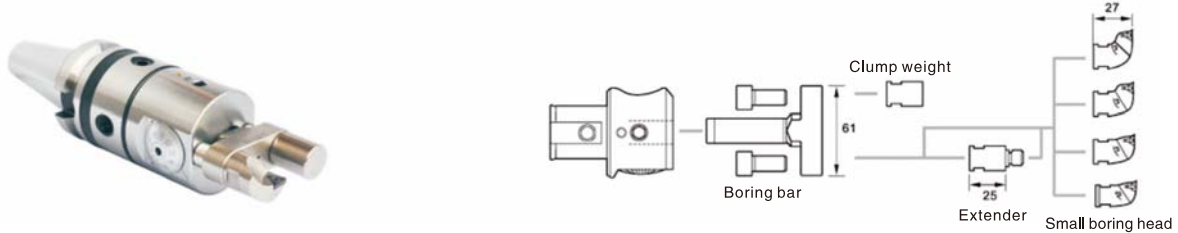

	Ordering Code	Stock	Processing diameter Φd	EW boring head	Boring bar	Clump weight	Extender	Small boring head	Blade
	BJ16BE36A	○	0.5-9	WBH2-50LBK6 (1.05Kg)	ST16-SL27-55 (0.20Kg)	BW-M10 (0.02Kg)	M1010-25 (0.02Kg)	BE36A	TP08
	BJ16BE28A	○	9-17					BE28A	
	BJ16BE22A	○	17-23					BE22A	
	BJ16BE18A	○	23-27					BE18A	
<p>1. The maximum, minimum diameter of processing is the use of nose radius R0.2 insert value; 2. Without blade, please order; 3. The processing, the spindle should be reversed; 4. Please note the eccentric changes when the interference range will also change.</p>									

Outside diameter boring series

L type Processing range: $\Phi 21 \sim \Phi 662$



Ordering Code	Stock	dm	L	D	Insert	Boring	Clump weight	Clamp	Screw	Screw	Wrench	Weight
CDH-D8-55-78L	●	32	84	8-55	TP..1103	CKB4-EVN4671	CKB4-PHK	CDH-CKB4	NLJ-M8	M5*13	T20	3
CDH-D30-120-78L	●			30-120								4.8

1. The maximum, minimum diameter of processing is the use of tool nose radius R0.4 insert value;
2. WBH boring head with 1 blade holder (ENF4-1), but not with the blade, please order;
3. The processing, the spindle should be reversed;
4. The use of FL135, FL200 nose direction and drive health direction and please, when using the FL135/90, FL200/90 tip direction and perpendicular to the direction of transmission key.

● Stock ○ Available upon Order

Turning inserts

External turning

Internal turning

Grooving & parting

Threading

Milling

Boring & drilling

Tool holder

Solid carbide end mills

Solid carbide drill & taps

Technical information

WBJ16 Fine-tune Precision Boring Tools

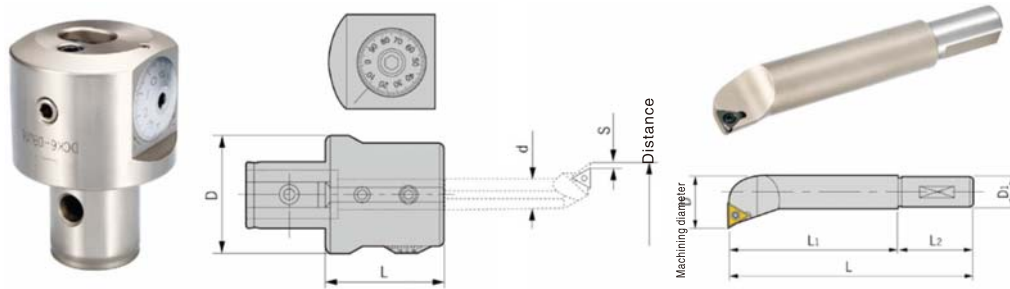

Ordering Code	Stock	Boring Range	D	d	L	Tuning precision	Stroke	Weight(Kg)
WBJ16	●	Φ6-Φ50	63	16	50	Φ0.01mm	6.0mm	1.2

Ordering Code	Stock	Boring Range	D1	L1	L	Applicable Insert	Clamp Screw	Spanner	Weight(Kg)
WBJ-1606-24	○	6-9	16	24	73	WBG0601...L	M2x4	T6	0.014
WBJ-1608-32	●	8-11		32	80	TBGT0601...L	M2x5		0.077
WBJ-1610-40	●	10-13		40	87				0.082
WBJ-1612-53	●	12-17		53	98	TPGH0902...L	M2.5x6	T8	0.095
WBJ-1616-53	●	16-21		68	110				0.143
WBJ-1620-83	●	20-26		83	125				0.203
WBJ-1625-90	●	25-31		90	128				0.275
WBJ-1630-90	●	30-42		90	128	TPGH1103...L	M3.0x7	T8	0.275
WBJ-1640-90	●	40-50		90	128				0.286

WBJ16 Fine-tune Precision Boring Tools(8PCS)

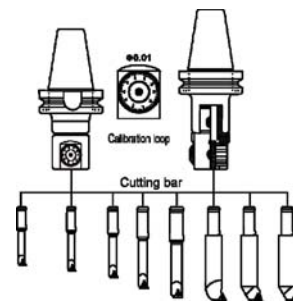

Ordering Code	Stock	Boring Range	Spindle Handle Model	Head NO.	Bar Keep Out	Weight(Kg)
BT40-WBJ16-8P	●	8-50	BT40-LBK6-55	16	WBJ-16..	9.1
BT50-WBJ16-8P	●	8-50	BT50-LBK6-65		WBJ-16..	11.7
NT40-WBJ16-8P	●	8-50	NT40-LBK6-55		WBJ-16..	8.5
NT50-WBJ16-8P	●	8-50	NT50-LBK6-55		WBJ-16..	10.3
SK40-WBJ16-8P	●	8-50	SK40-LBK6-55		WBJ-16..	6.9
SK50-WBJ16-8P	●	8-50	SK50-LBK6-65		WBJ-16..	10.5

●Stock ○Available upon Order

Turning inserts

External turning

Internal turning

Grooving & parting

Threading

Milling

Boring & drilling

Tool holder

Solid carbide end mills

Solid carbide drill & taps

Technical information

Collet for Tungsten Carbide Small Diameter Modular Boring Bar Series Type EC

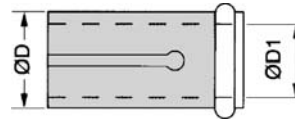

Ordering Code	Stock	D(mm)	d1(mm)	Applicable Carbide Tool Holder
EC1608	○	16	8	ST08.HC08
EC1610	○	16	10	ST10.HC10
EC1612	○	16	12	ST12.HC12
EC1614	○	16	14	St14

Tungsten Carbide Small Diameter Modular Boring Bar,ST Type

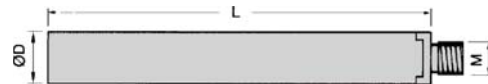

Ordering Code	Stock	L(mm)	D(mm)	M(mm)	Applicable Carbide Tool Holder	Applicable Bushing
ST08-W5-100L	●	100	8	M5	BE09A.BE10.5A	EC1608
ST10-W6-110L	●	110	10	M6	BE12A	EC1610
ST12-W6-120L	●	120	12		BE14A.BE16A	EC1612
ST14-W6-160L	●	160	14		BE16A	EC1614
ST16-W10-160L	●	160	16	M10	BE18A BE20A BE22A BE24A BE26A BE28A BE30A BE32A BE34A BE36A BE38A BE40A	-

Boring Head, BE Type 《 Boring Range Φ9-Φ50mm 》

	Ordering Code	Stock	d(mm)	H(mm)	L(mm)	M(mm)	Insert	Clamp Screw	Wrench
	BE09A	●	9	7	18	M5	TP..0802..	M2,2	T7
	BE10.5A	●	10.5						
	BE12A	●	12	10	23	M6			
	BE14A	●	14						
	BE16A	●	16						
	BE18A	●	18						
	BE20A	●	20	14	27	M10			
	BE22A	●	22						
	BE24A	●	24						
	BE26A	●	26						
	BE28A	●	28						
	BE30A	●	30						
	BE32A	●	32						
	BE34A	●	34						
	BE36A	●	36						
	BE38A	●	38						
BE40A	●	40							

● Stock ○ Available upon Order

Turning inserts

External turning

Internal turning

Grooving & parting

Threading

Milling

Boring & drilling

Tool holder

Solid carbide end mills

Solid carbide drill & taps

Technical information

NBH2084 Fine-tune Precision Boring Tools

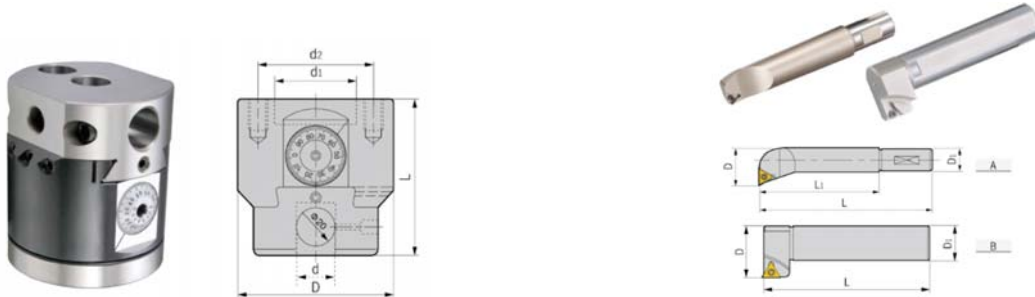

Ordering Code	Stock	D	d	d1	d2	L	Boring Range	Tuning precision	Stroke	Weight(Kg)
NBH2084	●	84	20	35	60	80	Φ8-Φ280	Φ0.01mm	28.0mm	3.0

Ordering Code	Stock	Boring Range	D1	L1	L	Applicable Inserts	Clamp Screw	Spanner	Weight(Kg)
SBJ-2008-32	●	8-11	20	32	80	TBGT0601..L	M2.0x5	T6	0.095
SBJ2010-40	●	10-13		40	87				0.095
SBJ2012-53	●	12-17		53	98	TPGH0902..L	M2.5x6	T8	0.12
SBJ2016-68	●	16-21		68	110				0.16
SBJ2020-83	●	20-130		83	123	TPGH1103..L	M3.0x7	T8	0.22
SBJ2025-96	●	25-135		96	137				0.34
SBJ2030-115	●	30-140		115	152				0.54
SBJ2020-L	●	120-280		84+BTL1	100				0.23

NBH2084 Fine-tune Precision Boring Tools(Set)

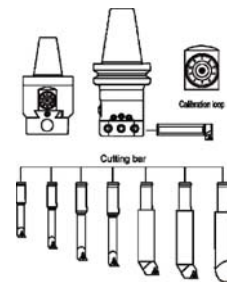

Ordering Code	Stock	Boring Range	Spinde Handle Model	Head NO.	Bar Keep Out	Weight(Kg)
BT40-NBH2084-8P	●	08-280	BT40-NBH-50	NBH2084	SBJ-20..	9.5
BT50-NBH2084-8P	●	08-280	BT50-NBH-55		SBJ-20..	12.0
NT40-NBH2084-8P	●	08-280	NT40-NBH-50		SBJ-20..	9.3
NT50-NBH2084-8P	●	08-280	NT50-NBH-55		SBJ-20..	10.8
SK40-NBH2084-8P	●	08-280	SK40-NBH-50		SBJ-20..	9.5
SK50-NBH2084-8P	●	08-280	SK50-NBH-55		SBJ-20..	12.0
R8-NBH-2084-8P	●	08-280	R8-NBH-50		SBJ-20..	10.0

● Stock ○ Available upon Order

Turning inserts

External turning

Internal turning

Grooving & parting

Threading

Milling

Boring & drilling

Tool holder

Solid carbide end mills

Solid carbide drill & taps

Technical information

Super Hard Solid Tungsten Carbide Boring Bar

《Boring Range form $\Phi 20$ – $\Phi 75$ mm》

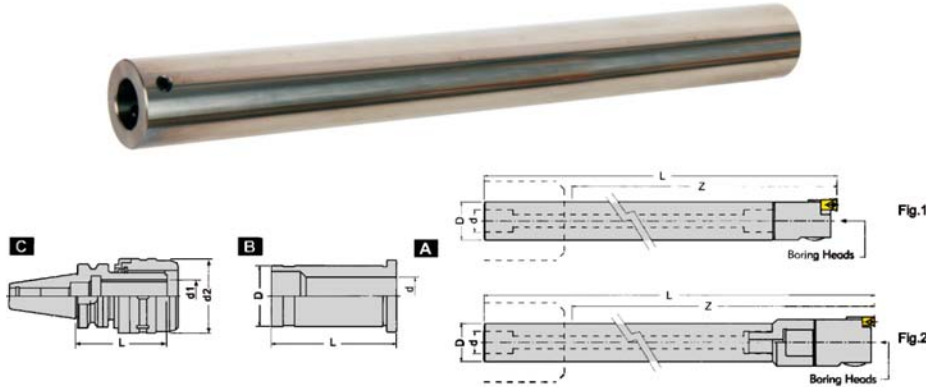

Ordering Code	Stock	Fig	Φ dmm Internal Dia.	Dmm External Dia.	L(mm)	Z(mm)	Applicable Boring Heads	Weight (Kg)
SC19-CKB1-150L	●	1	11	19	225	150	CKB1	0.8
SC19-CKB1-200L	●				275	200	CKB1	1
SC24-CKB2-180L	●		14	24	260	180	CKB2	1.45
SC24-CKB2-240L	●				320	240	CKB2	1.8
SC32-CKB3-240L	●	2	18	32	320	240	CKB3	2.8
SC32-CKB3-310L	●				390	310	CKB3	3.2
SC32-CKB3-280L	●	2	22	39	365	280	CKB3	3.1
SC32-CKB4-280L	●				365	280	CKB4	3.1
SC32-CKB3-350L	●	2	18	32	435	350	CKB3	3.8
SC32-CKB4-350L	●				435	350	CKB4	3.8
SC40-CKB4-310L	●	1	22	40	390	310	CKB4	5
SC40-CKB4-400L	●				480	400	CKB4	6.5
SC40-CKB4-360L	●	2	22	40	445	360	CKB4	5.6
SC40-CKB5-360L	●				445	360	CKB5	5.6
SC40-CKB4-450L	●	2	22	40	535	450	CKB4	7.1
SC40-CKB5-450L	●				535	450	CKB5	7.1

1. Super hard tungsten carbide boring bar made from high toughness compound is tough and durable, highly materializing features of super hardness, high rigidity and extra vibration resistance, most suitable for extra depth boring (10D);
2. Standard internal coolant hole is built in every size of the bar, best for cooling and chip evacuation in deep hole boring;
3. Featuring straight shank structure, the bar can be adjusted to different working lengths;
4. On both ends of main body integrated are soldering holes. One hole will be superseded by the other upon breaking. This will reduce your cost greatly increase the value of boring bar.

★ Boring head is not included

★ CKB3/4 and CKB4/5 are extensions with magnifying diameter

● Stock ○ Available upon Order

Turning inserts

External turning

Internal turning

Grooving & parting

Threading

Milling

Boring & drilling

Tool holder

Solid carbide end mills

Solid carbide drill & taps

Technical information

LBK Boring Holder

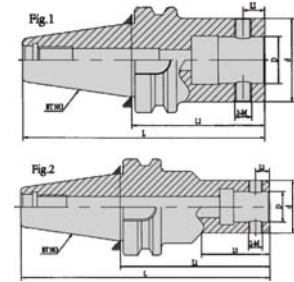

Ordering Code	Stock	Type	L	L2	D	d	D1	G	Weight
BT30-CKB1-80	●	Fig.1	80	46	19	11	31	M4x0.5	0.75
BT30-CKB2-80	●		80	46	24	14	31	M5x0.5	0.83
BT30-CKB3-80	●		80	58	31	18	31	M6x0.75	0.91
BT30-CKB4-80	●		80	58	39	22	39	M8x0.75	1.02
BT40-CKB1-85	●		85	49	19	11	31	M4x0.5	1.18
BT40-CKB1-115	●		115	79	19	11	31	M4x0.5	1.21
BT40-CKB2-85	●		85	49	24	14	31	M5x0.5	1.21
BT40-CKB2-115	●		115	79	24	14	31	M5x0.5	1.27
BT40-CKB3-95	●		95	68	31	18	31	M6x0.75	1.32
BT40-CKB3-125	●		125	80	31	18	37	M6x0.75	1.46
BT40-CKB3-155	●	Fig.2	155	85	31	18	37	M6x0.75	1.62
BT40-CKB4-95	●	Fig.1	95	68	39	22	39	M8x0.75	1.54
BT40-CKB4-125	●		125	98	39	22	39	M8x0.75	1.86
BT40-CKB4-155	●	Fig.2	155	128	39	22	46	M8x0.75	2.15
BT40-CKB4-185	●		185	120	39	22	46	M8x0.75	2.42
BT40-CKB5-95	●	Fig.1	95	68	49	28	49	M10x1	1.81
BT40-CKB5-125	●		125	98	49	28	49	M10x1	2.35
BT40-CKB5-155	●		155	128	49	28	49	M10x1	2.75
BT40-CKB5-185	●		185	155	49	28	49	M10x1	3.05
BT40-CKB6-95	●		95	68	63	36	63	M12x1	2.75
BT40-CKB6-125	●		125	98	63	36	63	M12x1	3.20
BT40-CKB6-155	●	Fig.2	155	128	63	36	63	M12x1	3.40
BT40-CKB6-185	●		185	158	63	36	63	M12x1	3.60
BT50-CKB1-110	●		110	67	19	11	27	M4x0.5	3.93
BT50-CKB1-145	●	Fig.2	145	75	19	11	27	M4x0.5	4.05
BT50-CKB2-110	●	Fig.1	110	67	24	14	31	M5x0.5	4.08
BT50-CKB2-145	●	Fig.2	145	75	24	14	35	M5x0.5	4.20
BT50-CKB3-125	●	Fig.1	125	75	31	18	36	M6x0.75	4.10
BT50-CKB3-165	●	Fig.2	165	90	31	18	36	M6x0.75	4.35
BT50-CKB4-125	●	Fig.1	125	82	39	22	45	M8x0.75	4.35
BT50-CKB4-165	●		165	95	39	22	45	M8x0.75	4.70
BT50-CKB4-205	●	Fig.2	205	110	39	22	45	M8x0.75	5.02
BT50-CKB5-125	●	Fig.1	125	82	49	28	49	M10x1	4.75
BT50-CKB5-165	●		165	95	49	28	58	M10x1	5.20
BT50-CKB5-205	●	Fig.2	205	110	49	28	58	M10x1	5.53
BT50-CKB5-245	●		245	150	49	28	58	M10x1	5.95
BT50-CKB6-125	●	Fig.1	125	87	63	36	73	M12x1	5.15
BT50-CKB6-165	●		165	127	63	36	73	M12x1	6.10
BT50-CKB6-205	●	Fig.2	205	165	63	36	73	M12x1	7.40
BT50-CKB6-245	●		245	150	63	36	73	M12x1	7.75
BT50-CKB6-285	●		285	185	63	36	73	M12x1	8.10

● Stock ○ Available upon Order

Extension(Constant Diameter)

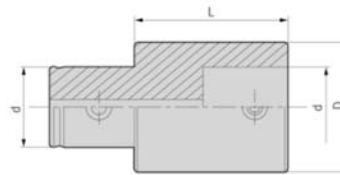

Ordering Code	Stock	d (mm)	D (mm)	L (mm)	Applicable Boring Heads	Weight (Kg)
CKB1-1-30L	●	11	19	30	CKB1	0.07
CKB2-2-30L	●	14	24	30	CKB2	0.1
CKB3-3-30L	●	18	31	30	CKB3	0.15
CKB4-4-45L	●	22	39	45	CKB4	0.4
CKB5-5-60L	●	28	50	60	CKB5	0.8
CKB6-6-60L	●	36	64	60	CKB6	1.4

Extension(Reducing)

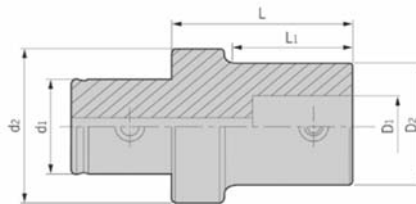

Ordering Code	Stock	d1 (mm)	d2 (mm)	D1 (mm)	D2 (mm)	L (mm)	L1 (mm)	Applicable Boring Heads	Weight (Kg)
CKB2-1-36L	●	14	24	14	24	36	30	CKB2/CKB1	0.1
CKB3-1-41L	●	18	31	14	24	41	30	CKB3/CKB1	0.15
CKB3-2-37L	●			11	19	37	25	CKB3/CKB2	0.15
CKB4-1-58L	●	22	39	14	24	58	40	CKB4/CKB1	0.3
CKB4-2-50L	●			18	31	50	36	CKB4/CKB2	0.3
CKB4-3-50L	●			22	39	50	37	CKB4/CKB3	0.35
CKB5-1-60L	●	28	50	11	19	60	40	CKB5/CKB1	0.45
CKB5-2-54L	●			14	24	54	35	CKB5/CKB2	0.45
CKB5-2-74L	●			14	24	74	55	CKB5/CKB2	0.5
CKB5-3-47L	●			18	31	47	29	CKB5/CKB3	0.5
CKB5-3-72L	●			18	31	72	54	CKB5/CKB3	0.6
CKB5-4-42L	●			22	39	42	25	CKB5/CKB4	0.5
CKB5-4-67L	●			22	39	67	50	CKB5/CKB4	0.7
CKB6-1-70L	●			36	64	11	19	70	40
CKB6-2-63L	●	14	24			63	45	CKB6/CKB2	0.7
CKB6-2-93L	●	14	24			93	75	CKB6/CKB2	0.8
CKB6-3-56L	●	18	31			56	39	CKB6/CKB3	0.75
CKB6-3-96L	●	18	31			96	79	CKB6/CKB3	0.95
CKB6-4-51L	●	22	39			51	35	CKB6/CKB4	0.85
CKB6-4-101L	●	22	39			101	85	CKB6/CKB4	1.3
CKB6-5-41L	●	36	64			41	25	CKB6/CKB5	0.85
CKB6-5-91L	●	36	64			91	75	CKB6/CKB5	1.45

● Stock ○ Available upon Order

Turning inserts

External turning

Internal turning

Grooving & parting

Threading

Milling

Boring & drilling

Tool holder

Solid carbide end mills

Solid carbide drill & taps

Technical information

Turning inserts

External turning

Internal turning

Grooving & parting

Threading

Milling

Boring & drilling

Tool holder

Solid carbide end mills

Solid carbide drill & taps

Technical information

Large Size Boring Bar BT NO-DM-L1

- ⊙ BT NO taper shank executives At3 standard;
- ⊙ Tolerance for D inner bore;
- ⊙ Entire center cooling is good for through coolant and antivibration.

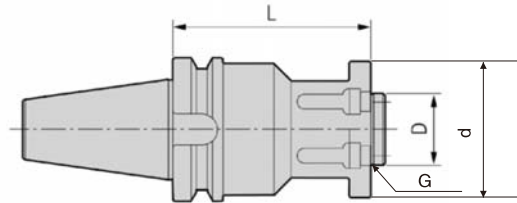

Ordering Code	Stock	L	D	d	G	Weight
BT40-DM32-60	●	60	100	32	4-M12	2.42
BT50-DM32-100	●	100	100	32	4-M12	6.3
BT50-DM32-150	●	150	100	32	4-M12	9.2
BT50-DM32-200	●	200	100	32	4-M12	11.1
BT50-DM32-250	●	250	100	32	4-M12	12.9
BT50-DM32-300	●	300	100	32	4-M12	14.8

● Stock ○ Available upon Order

TWN Twin-bit Rough Boring Head Operating Guide Line

- 1 Boring body
- 2 Insert holder
- 3 Insert screw
- 4 Insert
- 5 Locking screw
- 6 Adjusting screw

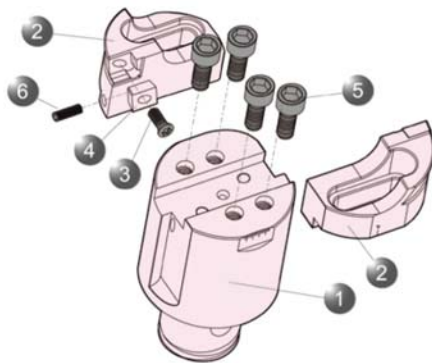

- Step 1: Clockwise (Locking)
 Step 3: Anticlockwise (Loosening)
 Step 2
 Step 4

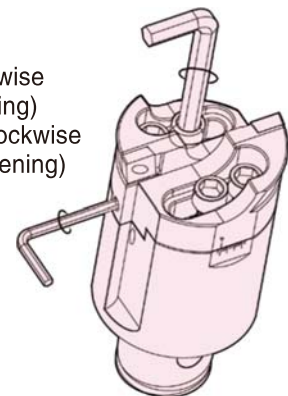

Sequence Of Use

Please operate the following step(1-6) according to the diagram figured:

Step1. Loosening the fixed screws on the blade bearing.

Step2. Rotating and adjusting the side screws to move the blade bearing to an scheduled processing dimension.

Step3. Locking the fixed screws on the blade bearing.

Step4. Using proper force to rotate and adjust the screws to avoid the screw loose during cutting.

EWN16 Fine-tune Precision Boring Operating manual

- ① CBH adapter
- ② Micro adjusting knob
- ③ CBH body
- ④ Insert holder
- ⑤ Locking screw
- ⑥ Oil hole

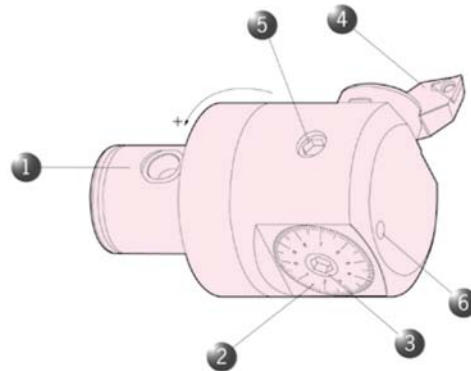

Sequence Of Use

Please operate the following step(1–5)according to the diagram figured:

Step1.Loosening the locking screws.

Step2.Rotating tune knob by clockwise to increase the processing diameter,the graduate is $\Phi 0.01$ mm.

Step3.Rotating by anti-clockwise will decrease the processing diameter.

Step4.When adjusting the size of processing,please fine-tuning by the direction to ensure mirco adjustment precision.

Step5.When meet the demanded size,please use proper force to lock the fasten screws.

WBJ16 Fine-tune Precision Boring Operating manual

- ① DBJ16 adapter
- ② Micro adjusting knob
- ③ Insert
- ④ DBJ16 body
- ⑤ Locking screw

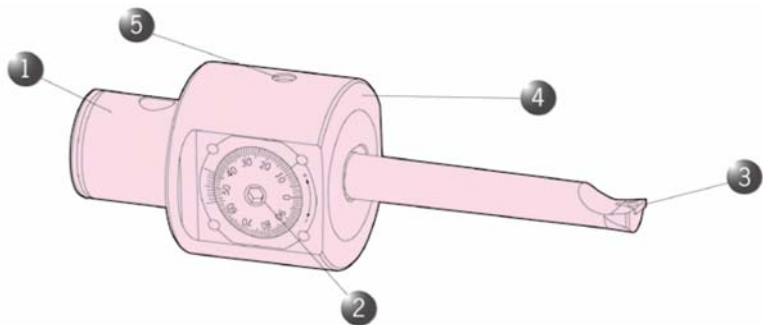

Sequence Of Use

Please operate the following step(1–6)according to the diagram figured:

Step1.Using special wrench to lock two M10 screws to fasten the cutting tools in the processing size range.

Step2.Loosening the fixed screws.

Step3.Rotating tune knob by clockwise to increase the processing diameter,the graduate is $\Phi 0.01$ mm.

Step4.Rotating by anti-clockwise will decrease the processing diameter.

Step5.When adjusting the size of processing,please fine-tuning by the same dircetion to ensure mirco adjustment precision.

Step6.When meet the demanded size,please use the proper force to lock the spindle orientation to makespindle fix into the substance.

SPMG2D Fast Drilling(U Drill)

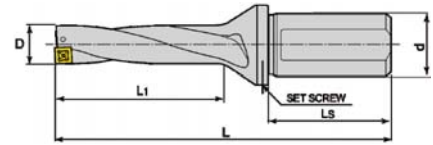

Ordering Code	Stock	D (mm)	L1 (mm)	L (mm)	d (mm)	LS (mm)	Insert	Screw	Wrench
C20-2D13-29SP05	●	13	29	88	20	50	SPMG050204	M2	T6
C20-2D13.5-30SP05	●	13.5	30	89					
C20-2D14-31SP05	●	14	31	90					
C20-2D14.5-32SP05	●	14.5	32	91					
C20-2D15-33SP05	●	15	33	92					
C20-2D15.5-34SP06	●	15.5	34	93					
C20-2D16-35SP06	●	16	35	94					
C20-2D16.5-36SP06	●	16.5	36	95					
C25-2D17-37SP06	●	17	37	108					
C25-3D17.5-38SP06	●	17.5	38	109					
C25-2D18-39SP06	●	18	39	110	25	56	SPMG060204	M2.2	T6
C25-2D18.5-40SP06	●	18.5	40	111					
C25-2D19-41SP06	●	19	41	112					
C25-2D19.5-42SP06	●	19.5	42	113					
C25-2D20-43SP06	●	20	43	114					
C25-2D20.5-44SP06	●	20.5	44	115					
C25-2D21-45SP06	●	21	45	116					
C25-2D21.5-46SP06	●	21.5	46	117					
C25-2D22-47SP07	●	22	47	118					
C25-2D22.5-48SP07	●	22.5	48	119					
C25-2D23-49SP07	●	23	49	123	32	60	SPMG07T38	M2.5	T8
C25-2D23.5-50SP07	●	23.5	50	124					
C25-2D24-51SP07	●	24	51	125					
C25-2D24.5-52SP07	●	24.5	52	126					
C25-2D25-53SP07	●	25	53	127					
C32-2D25.5-54SP07	●	25.5	54	134					
C32-2D26-55SP07	●	26	55	135					
C32-2D26.5-56SP07	●	26.5	56	136					
C32-2D27-57SP07	●	27	57	137					
C32-2D27.5-58SP07	●	27.5	58	138					
C32-2D28-59SP09	●	28	59	139	40	70	SPMG090408	M3.5	T15
C32-2D28.5-60SP09	●	28.5	60	140					
C32-2D29-62SP09	●	29	62	143					
C32-2D29.5-63SP09	●	29.5	63	144					
C32-2D30-64SP09	●	30	64	148					
C32-2D31-66SP09	●	31	66	150					
C32-2D32-68SP09	●	32	68	152					
C32-2D33-70SP09	●	33	70	154					
C32-2D34-72SP11	●	34	72	156					
C32-2D35-74SP11	●	35	74	158					
C32-2D36-76SP11	●	36	76	160	40	70	SPMG110408	M4M	T15
C32-2D37-79SP11	●	37	79	169					
C32-2D38-81SP11	●	38	91	171					
C40-2D39-83SP11	●	39	83	183					
C40-2D40-85SP11	●	40	85	185					
C40-2D41-87SP11	●	41	87	187					
C40-2D42-89SP14	●	42	89	189					
C40-2D43-91SP14	●	43	91	191					
C40-2D44-93SP14	●	44	93	193					
C40-2D45-95SP14	●	45	95	195					
C40-2D46-97SP14	●	46	97	197	40	70	SPMG140512	M5	T20
C40-2D47-99SP14	●	47	99	199					
C40-2D48-101SP14	●	48	101	201					
C40-2D49-103SP14	●	49	103	203					
C40-2D50-105SP14	●	50	105	205					

● Stock ○ Available upon Order

- Turning inserts
- External turning
- Internal turning
- Grooving & parting
- Threading
- Milling
- Boring & drilling
- Tool holder
- Solid carbide end mills
- Solid carbide drill & taps
- Technical information

SPMG3D Fast Drilling(U Drill)

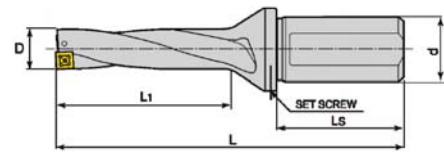

Ordering Code	Stock	D (mm)	L1 (mm)	L (mm)	d (mm)	LS (mm)	Insert	Screw	Wrench
C20-3D13-42SP05	●	13	42	101	20	50	SPMG050204	M2	T6
C20-3D13.5-44SP05	●	13.5	44	103					
C20-3D14-45SP05	●	14	45	104					
C20-3D14.5-47SP05	●	14.5	47	106					
C20-3D15-48SP05	●	15	48	107					
C20-3D15.5-50SP06	●	15.5	50	109					
C20-3D16-51SP06	●	16	51	110					
C20-3D16.5-53SP06	●	16.5	53	112					
C25-3D17-54SP06	●	17	54	125	25	56	SPMG060204	M2.2	T6
C25-3D17.5-56SP06	●	17.5	56	127					
C25-3D18-57SP06	●	18	57	128					
C25-3D18.5-59SP06	●	18.5	59	130					
C25-3D19-60SP06	●	19	60	131					
C25-3D19.5-62SP06	●	19.5	62	133					
C25-3D20-63SP06	●	20	63	134					
C25-3D20.5-65SP06	●	20.5	65	136					
C25-3D21-66SP06	●	21	66	137					
C25-3D21.5-68SP06	●	21.5	68	139					
C25-3D22-69SP07	●	22	69	140					
C25-3D22.5-71SP07	●	22.5	71	142					
C25-3D23-72SP07	●	23	72	146					
C25-3D23.5-74SP07	●	23.5	74	148					
C25-3D24-75SP07	●	24	75	149					
C25-3D24.5-77SP07	●	24.5	77	151					
C25-3D25-78SP07	●	25	78	152					
C32-3D25.5-80SP07	●	25.5	80	160	32	60	SPMG07T38	M2.5	T8
C32-3D26-81SP07	●	26	81	161					
C32-3D26.5-83SP07	●	26.5	83	163					
C32-3D27-84SP07	●	27	84	164					
C32-3D27.5-86SP07	●	27.5	86	166					
C32-3D28-87SP09	●	28	87	167					
C32-3D28.5-89SP09	●	28.5	89	169					
C32-3D29-91SP09	●	29	91	172					
C32-3D29.5-93SP09	●	29.5	93	174					
C32-3D30-94SP09	●	30	94	178					
C32-3D31-97SP09	●	31	97	181					
C32-3D32-100SP09	●	32	100	184					
C32-3D33-103SP09	●	33	103	187					
C32-3D34-106SP11	●	34	106	190					
C32-3D35-109SP11	●	35	109	193					
C32-3D36-112SP11	●	36	112	196					
C32-3D37-116SP11	●	37	116	206					
C32-3D38-119SP11	●	38	119	207					
C40-3D39-122SP11	●	39	122	222	40	70	SPMG090408	M3.5	T15
C40-3D40-125SP11	●	40	125	225					
C40-3D41-128SP11	●	41	128	228					
C40-3D42-131SP14	●	42	131	231					
C40-3D43-134SP14	●	43	134	234					
C40-3D44-137SP14	●	44	137	237					
C40-3D45-140SP14	●	45	140	240					
C40-3D46-143SP14	●	46	143	243					
C40-3D47-146SP14	●	47	146	246					
C40-3D48-149SP14	●	48	149	249					
C40-3D49-152SP14	●	49	152	252					
C40-3D50-155SP14	●	50	155	255					
C32-3D33-103SP09	●	33	103	187	32	60	SPMG110408	M4	T15
C32-3D34-106SP11	●	34	106	190					
C32-3D35-109SP11	●	35	109	193					
C32-3D36-112SP11	●	36	112	196					
C32-3D37-116SP11	●	37	116	206					
C32-3D38-119SP11	●	38	119	207					
C40-3D39-122SP11	●	39	122	222					
C40-3D40-125SP11	●	40	125	225					
C40-3D41-128SP11	●	41	128	228					
C40-3D42-131SP14	●	42	131	231	40	70	SPMG140512	M5	T20
C40-3D43-134SP14	●	43	134	234					
C40-3D44-137SP14	●	44	137	237					
C40-3D45-140SP14	●	45	140	240					
C40-3D46-143SP14	●	46	143	243					
C40-3D47-146SP14	●	47	146	246					
C40-3D48-149SP14	●	48	149	249					
C40-3D49-152SP14	●	49	152	252					
C40-3D50-155SP14	●	50	155	255					

● Stock ○ Available upon Order

Turning inserts

External turning

Internal turning

Grooving & parting

Threading

Milling

Boring & drilling

Tool holder

Solid carbide end mills

Solid carbide drill & taps

Technical information

SPMG4D Fast Drilling(U Drill)

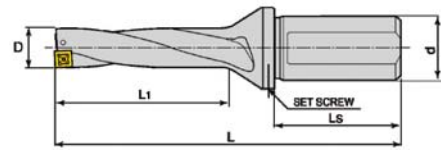

Ordering Code	Stock	D (mm)	L1 (mm)	L (mm)	d (mm)	LS (mm)	Insert	Screw	Wrench
C20-4D13-55SP05	●	13	55	114	20	50	SPMG050204	M2	T6
C20-4D13.5-57SP05	●	13.5	57	116					
C20-4D14-59SP05	●	14	59	118					
C20-4D14.5-61SP05	●	14.5	61	120					
C20-4D15-63SP05	●	15	63	122					
C20-4D15.5-65SP06	●	15.5	65	124					
C20-4D16-67SP06	●	16	67	126					
C20-4D16.5-69SP06	●	16.5	69	128					
C25-4D17-71SP06	●	17	71	142					
C25-4D17.5-73SP06	●	17.5	73	144					
C25-4D18-75SP06	●	18	75	146					
C25-4D18.5-77SP06	●	18.5	77	148					
C25-4D19-79SP06	●	19	79	150					
C25-4D19.5-81SP06	●	19.5	81	152					
C25-4D20-83SP06	●	20	83	154					
C25-4D20.5-85SP06	●	20.5	85	156					
C25-4D21-87SP06	●	21	87	158					
C25-4D21.5-89SP06	●	21.5	89	160					
C25-3D22-91SP07	●	22	91	162					
C25-4D22.5-93SP07	●	22.5	93	164					
C25-4D23-95SP07	●	23	95	169					
C25-4D23.5-97SP07	●	23.5	97	171					
C25-4D24-99SP07	●	24	99	173					
C25-4D24.5-101SP07	●	24.5	101	175					
C25-4D25-103SP07	●	25	103	177					
C32-4D25.5-105SP07	●	25.5	105	185					
C32-4D26-107SP07	●	26	107	187					
C32-4D26.5-109SP07	●	26.5	109	189					
C32-4D27-111SP07	●	27	111	191					
C32-4D27.5-113SP07	●	27.5	113	193					
C32-4D28-115SP09	●	28	115	195					
C32-4D28.5-117SP09	●	28.5	117	197					
C32-4D29-120SP09	●	29	120	201					
C32-4D29.5-122SP09	●	29.5	122	203					
C32-4D30-124SP09	●	30	124	208					
C32-4D31-128SP09	●	31	128	212					
C32-4D32-132SP09	●	32	132	216					
C32-4D33-136SP09	●	33	136	220					
C32-4D34-140SP11	●	34	140	224					
C32-4D35-144SP11	●	35	144	228					
C32-4D36-148SP11	●	36	148	232					
C32-4D37-153SP11	●	37	153	243					
C32-4D38-157SP11	●	38	157	247					
C40-4D39-161SP11	●	39	161	261					
C40-4D40-165SP11	●	40	165	265					
C40-4D41-169SP11	●	41	169	269					
C40-4D42-173SP14	●	42	173	273					
C40-4D43-177SP14	●	43	177	277					
C40-4D44-181SP14	●	44	181	281					
C40-4D45-185SP14	●	45	185	285					
C40-4D46-189SP14	●	46	189	289					
C40-4D47-193SP14	●	47	193	293					
C40-4D48-197SP14	●	48	197	297					
C40-4D49-201SP14	●	49	201	301					
C40-4D50-205SP14	●	50	205	305					

● Stock ○ Available upon Order

- Turning inserts
- External turning
- Internal turning
- Grooving & parting
- Threading
- Milling
- Boring & drilling
- Tool holder
- Solid carbide end mills
- Solid carbide drill & taps
- Technical information

WCMX3D Fast Drilling(U Drill)

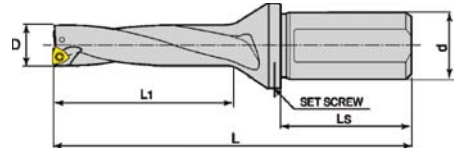

Ordering Code	Stock	D (mm)	L1 (mm)	L (mm)	DS (mm)	LS (mm)	Insert	Screw	Wrench					
C25-3D15-48WC03	●	15	48	119	25	56	WCMX030208	M2.5	T8					
C25-3D15.5-50WC03	●	15.5	50	121										
C25-3D16-51WC03	●	16	51	122										
C25-3D16.5-53WC03	●	16.5	53	124										
C25-3D17-54WC03	●	17	54	125										
C25-3D17.5-56WC03	●	17.5	56	127										
C25-3D18-57WC03	●	18	57	128										
C25-3D18.5-59WC03	●	18.5	59	130										
C25-3D19-60WC03	●	19	60	131										
C25-3D19.5-62WC03	●	19.5	62	133										
C25-3D20-63WC03	●	20	63	134										
C25-3D20.5-65WC03	●	20.5	65	136										
C25-3D21-66WC04	●	21	66	137										
C25-3D21.5-68WC04	●	21.5	68	139										
C25-3D22-69WC04	●	22	69	140										
C25-3D22.5-71WC04	●	22.5	71	142										
C25-3D23-72WC04	●	23	72	146										
C25-3D23.5-74WC04	●	23.5	74	148										
C25-3D24-75WC04	●	24	75	149										
C25-3D24.5-77WC04	●	24.5	77	151										
C25-3D25-78WC05	●	25	78	152	32	60	WCMX050308	M3	T8					
C32-3D25.5-80WC05	●	25.5	80	160										
C32-3D26-81WC05	●	26	81	161										
C32-3D26.5-83WC05	●	26.5	83	163										
C32-3D27-84WC05	●	27	84	164										
C32-3D28-87WC05	●	28	87	167										
C32-3D29-91WC05	●	29	91	172										
C32-3D30-94WC05	●	30	94	178										
C32-3D31-97WC06	●	31	97	181										
C32-3D32-100WC06	●	32	100	184										
C32-3D33-103WC06	●	33	103	187										
C32-3D34-106WC06	●	34	106	190										
C32-3D35-109WC06	●	35	109	193										
C32-3D36-112WC06	●	36	112	196										
C32-3D37-116WC06	●	37	116	206										
C32-3D38-119WC06	●	38	119	209										
C40-3D39-122WC06	●	39	122	222						40	70	WCMX06T308	M3.5	T15
C40-3D40-125WC06	●	40	125	225										
C40-3D41-128WC06	●	41	128	228										
C40-3D42-131WC06	●	42	131	231										
C40-3D43-134WC06	●	43	134	234										
C40-3D44-137WC06	●	44	137	237										
C40-3D45-140WC06	●	45	140	240										
C40-3D46-143WC06	●	46	143	243										
C40-3D47-146WC06	●	47	146	246										
C40-3D48-149WC08	●	48	149	249										
C40-3D49-152WC06	●	49	152	252										
C40-3D50-155WC08	●	50	155	255										
C40-3D51-158WC08	●	51	158	258										
C40-3D52-161WC08	●	52	161	261										
C40-3D53-164WC08	●	53	164	264										
C40-3D54-167WC08	●	54	167	267										
C40-3D55-170WC08	●	55	170	270										
C40-3D56-176WC08	●	56	176	278										
C40-3D57-179WC08	●	57	179	281										
C40-3D58-182WC08	●	58	182	284										
C40-3D59-185WC08	●	59	185	287										
C40-3D60-188WC08	●	60	188	290										

● Stock ○ Available upon Order

WCMX4D Fast Drilling(U Drill)

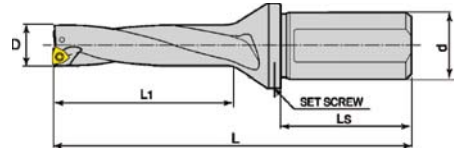

Ordering Code	Stock	D (mm)	L1 (mm)	L (mm)	DS (mm)	LS (mm)	Insert	Screw	Wrench
C25-4D15-63WC03	●	15	63	134	25	56	WCMX030208	M2.5	T8
C25-4D15.5-65WC03	●	15.5	65	136					
C25-4D16-67WC03	●	16	67	138					
C25-4D16.5-69WC03	●	16.5	69	140					
C25-4D17-71WC03	●	17	71	142					
C25-4D17.5-73WC03	●	17.5	73	144					
C25-4D18-75WC03	●	18	75	146					
C25-4D18.5-77WC03	●	18.5	77	148					
C25-4D19-79WC03	●	19	79	150					
C25-4D19.5-81WC03	●	19.5	81	152					
C25-4D20-83WC03	●	20	83	156					
C25-4D20.5-85WC03	●	20.5	85	158					
C25-4D21-87WC04	●	21	87	160					
C25-4D21.5-89WC04	●	21.5	89	162					
C25-4D22-91WC04	●	22	91	164					
C25-4D22.5-93WC04	●	22.5	93	179					
C25-4D23-95WC04	●	23	95	171					
C25-4D23.5-97WC04	●	23.5	97	173					
C25-4D24-99WC04	●	24	99	175					
C25-4D24.5-101WC04	●	24.5	101	177					
C25-4D25-103WC05	●	25	103	185					
C32-4D25.5-105WC05	●	25.5	105	187					
C32-4D26-107WC05	●	26	107	189					
C32-4D26.5-109WC05	●	26.5	109	191					
C32-4D27-111WC05	●	27	111	193					
C32-4D28-115WC05	●	28	115	195					
C32-4D29-120WC05	●	29	120	201					
C32-4D30-124WC05	●	30	124	208					
C32-4D31-128WC06	●	31	128	212					
C32-4D32-132WC06	●	32	132	216					
C32-4D33-136WC06	●	33	136	220					
C32-4D34-140WC06	●	34	140	224					
C32-4D35-144WC06	●	35	144	228					
C32-4D36-148WC06	●	36	148	232					
C32-4D37-153WC06	●	37	153	243					
C32-4D38-157WC06	●	38	157	247					
C40-4D39-161WC06	●	39	161	261					
C40-4D40-165WC06	●	40	165	265					
C40-4D41-169WC06	●	41	169	269					
C40-4D42-173WC06	●	42	173	273					
C40-4D43-177WC06	●	43	177	277					
C40-4D44-181WC06	●	44	181	281					
C40-4D45-185WC06	●	45	185	285					
C40-4D46-189WC06	●	46	189	289					
C40-4D47-193WC06	●	47	193	293					
C40-4D48-197WC08	●	48	197	297					
C40-4D49-201WC06	●	49	201	301					
C40-4D50-205WC08	●	50	205	305					
C40-4D51-209WC08	●	51	209	309					
C40-4D52-213WC08	●	52	213	313					
C40-4D53-217WC08	●	53	217	317					
C40-4D54-221WC08	●	54	221	321					
C40-4D55-225WC08	●	55	225	325					
C40-4D56-232WC08	●	56	232	334					
C40-4D57-236WC08	●	57	236	338					
C40-4D58-240WC08	●	58	240	342					
C40-4D59-244WC08	●	59	244	346					
C40-4D60-248WC08	●	60	248	350					

● Stock ○ Available upon Order

Turning inserts

External turning

Internal turning

Grooving & parting

Threading

Milling

Boring & drilling

Tool holder

Solid carbide end mills

Solid carbide drill & taps

Technical information

Turning inserts

SPMG-DG Drilling Inserts



M P

The material
 ● P1115
 ○ P1225

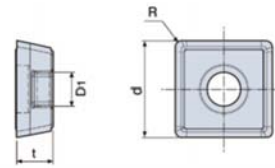

Ordering Code	NS4125	d(mm)	t(mm)	R(mm)	D1(mm)
SPMG 050204 NM	●	5.00	2.38	0.4	2.25
SPMG 060204 NM	●	6.00	2.38	0.4	2.61
SPMG 07T308 NM	●	7.94	3.97	0.8	2.85
SPMG 090408 NM	●	9.80	4.30	0.8	4.05
SPMG 110408 NM	●	11.50	4.80	0.8	4.45
SPMG 120408 NM	●	12.70	4.76	0.8	4.37
SPMG 140512 NM	●	14.30	5.20	1.2	5.75

External turning

Internal turning

Grooving & parting

Threading

SPGG-DA Drilling Inserts



N

The material
 ● N9115
 ○ N9225

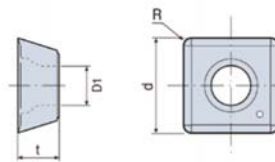

Ordering Code	NN9125	d(mm)	t(mm)	R(mm)	D1(mm)
SPMG 050204 NL	○	5.00	2.38	0.4	2.25
SPMG 060204 NL	○	6.00	2.38	0.4	2.61
SPMG 07T308 NL	○	7.94	3.97	0.8	2.85
SPMG 090408 NL	○	9.80	4.30	0.8	4.05
SPMG 110408 NL	○	11.50	4.80	0.8	4.45
SPMG 140512 NL	○	14.30	5.20	1.2	5.75

Milling

Boring & drilling

Tool holder

WCMX-WCGX-S Drilling Inserts



M P

The material
 ● P1115
 ○ P1225

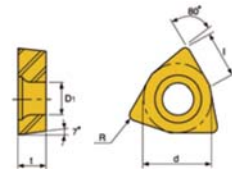

Ordering Code	NM1115	d(mm)	t(mm)	R(mm)	D1(mm)	l(mm)
WCMX 030204-NM	●	5.56	2.38	0.4	2.55	3.8
WCMX 040204-NM	●	6.35	2.38	0.4	2.8	4.3
WCMX 050308-NM	●	7.94	3.18	0.8	3.4	5.4
WCMX 06T308-NM	●	9.52	3.97	0.8	4.4	6.5
WCMX 080408-NM	●	12.70	4.76	0.8	5.5	8.7

Solid carbide end mills

Solid carbide drill & taps

Technical information

● Stock ○ Available upon Order

Eccentric Sleeve

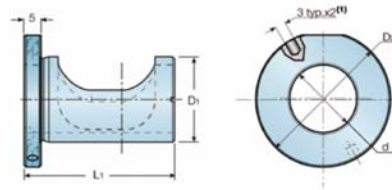

Ordering Code	Stock	d(mm)	D1(mm)	R(mm)	D2(mm)
PXTD 20x25	●	20	25	50	88
PXTD 25x32	●	25	32	50	94
PXTD 32x40	●	32	45	60	152
PXTD 40x50	●	40	50	60	157

Milling Application

When milling machine processing, such as the diameter of the need to change the normal processing adjustable axial location of eccentric sleeve.

If want to enlarge the aperture, clockwise rotating sleeve;
If want to reduce the aperture, the socket counterclockwise, specific as follows;
Bit diameter: 30mm

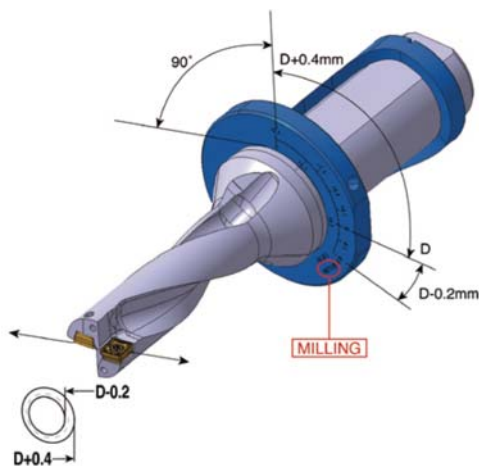

Lathe Application

Axial and eccentric sleeve can drill spindle axial overlap in the range of 0.2mm (the eccentric sleeve counterclockwise to increase the aperture adjustment)

When used in lathe processing, eccentric sleeve bit adjustable axial with spindle axial position

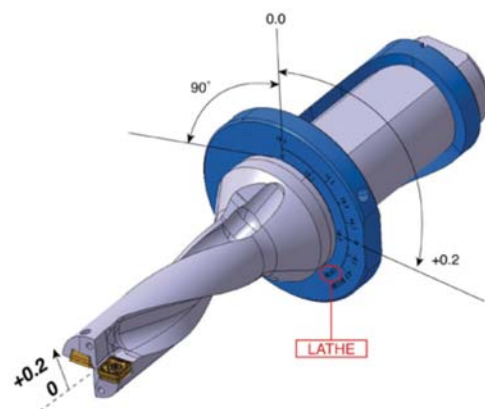

Turning inserts

External turning

Internal turning

Grooving & parting

Threading

Milling

Boring & drilling

Tool holder

Solid carbide end mills

Solid carbide drill & taps

Technical information

Lathe application technical information

Bit installation and test

First hole drilling processing—first 3mm–6mm depth when the blade, detecting core diameter range should be 0.2mm to 0.7mm

If you do not produce core diameter:

- blade and vibration drilling processing will produce crack
- please rotating drill shank of 180 degrees and then to test

If you core diameter size beyond the recommended data:

- please adjust offset the core diameter control in the recommended range
- otherwise the drilling process will cause overload and vibration

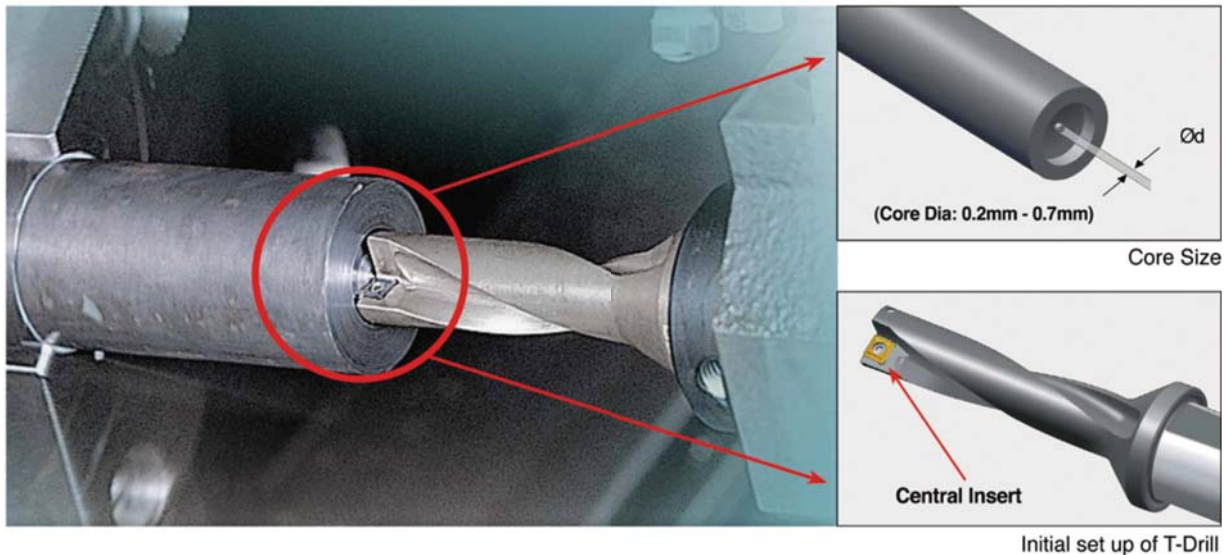

Cutting parameter for fast drill

Material	Carbon steel S50C, Q235		Alloy steel 25–35HRC 4Cr5MoSiV1, Cr12		Stainless steel SUS304, 316, OCr19Ni9		Cast iron HT250, QT450		Aluminium alloy	
	Vc=m/min	f=mm/rev	Vc=m/min	f=mm/rev	Vc=m/min	f=mm/rev	Vc=m/min	f=mm/rev	Vc=m/min	f=mm/rev
Speed										
Dc										
12.5–15		0.05–0.12		0.06–0.12		0.05–0.10		0.06–0.12		0.06–0.12
16–21		0.06–0.15		0.08–0.15		0.06–0.12		0.08–0.15		0.08–0.15
22–28		0.06–0.18		0.10–0.20		0.08–0.15		0.10–0.20		0.10–0.20
29–33	160–250	0.07–0.20	120–180	0.12–0.25	150–200	0.09–0.16	150–250	0.12–0.25	250–350	0.12–0.20
34–41		0.08–0.25		0.12–0.25		0.10–0.18		0.15–0.25		0.12–0.25
42–50		0.08–0.25		0.12–0.25		0.10–0.20		0.18–0.30		0.12–0.25
51–60		0.06–0.15		0.08–0.15		0.06–0.12		0.10–0.20		0.12–0.25

Non standard size

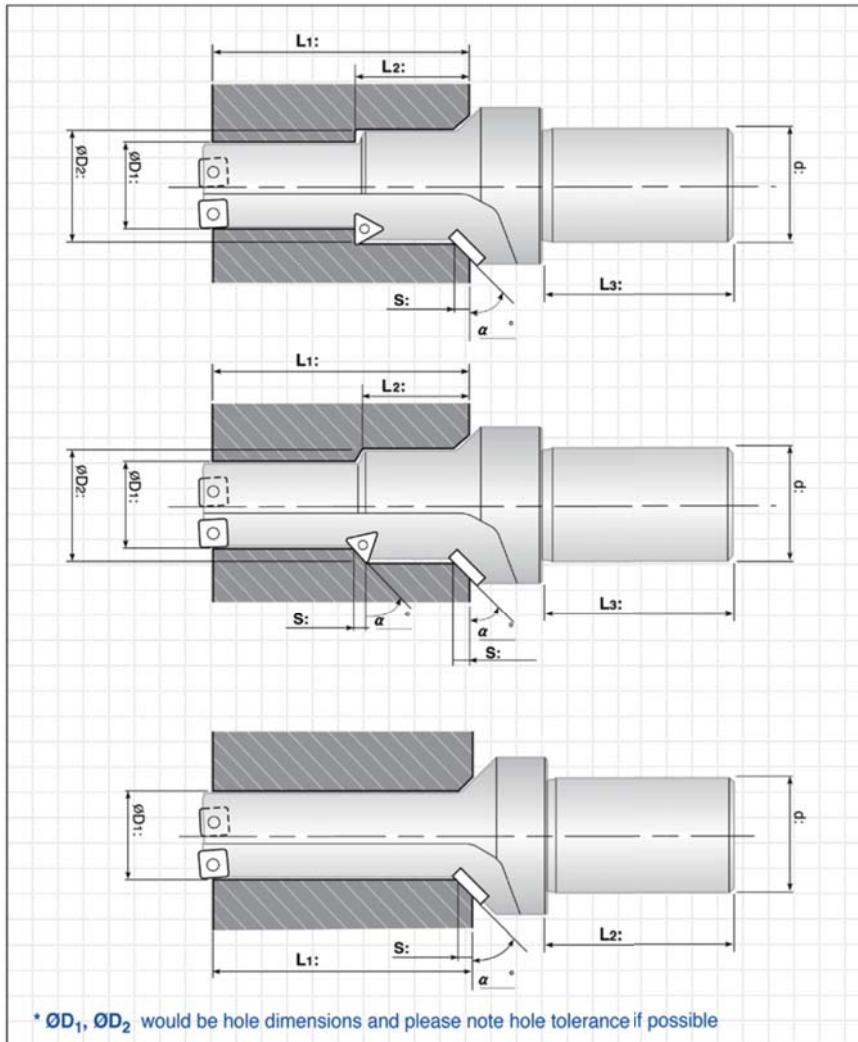

Comment

■ **Customer :** _____ ■ **Contact :** _____
 ■ **Address:** _____
 ■ **Telephone:** _____ ■ **Fax:** _____
 ■ **E-mail:** _____

Shank type

Cylindrical shank (ISO 9766)

Weldon shank

Whistle notch shank

Coolant supply

• Internal

• External

Machine Type

• Horizontal

• Vertical

Hole Type

• Blind hole

• Through hole

Workpieces

• Part: _____

• Material: _____

• Hardness: _____

Quantity

• _____ pcs

- Turning inserts
- External turning
- Internal turning
- Grooving & parting
- Threading
- Milling
- Boring & drilling
- Tool holder
- Solid carbide end mills
- Solid carbide drill & taps
- Technical information