

Milling tools



Recommended Cutting Data

Workpiece Materials	Materials Hardness	Grade	Recommended Cutting Speed Vc (m/min)	mm/tooth			
				Light Cutting	Medium Cutting	Heavy Cutting	
P	Low Carbon Steel	≤HB180	NS4115 NS4125 NP115T	180 (150-220)	0.08 (0.05-0.15)	0.1 (0.08-0.15)	0.12 (0.08-0.2)
					0.08 (0.05-0.15)	0.12 (0.08-0.18)	0.15 (0.1-0.25)
					0.15 (0.1-0.25)	0.2 (0.15-0.3)	0.25 (0.2-0.35)
	Carbon Steel, Alloy Steel	HB180-350	NS4115 NS4125	160 (140-200)	0.18 (0.1-0.25)	0.25 (0.1-0.35)	0.3 (0.1-0.45)
					0.08 (0.05-0.15)	0.1 (0.08-0.15)	0.12 (0.08-0.2)
					0.08 (0.05-0.15)	0.12 (0.08-0.18)	0.15 (0.1-0.25)
	Per-hardened Steel	HRC35-45	NS4115 NS4125	120 (100-160)	0.15 (0.1-0.25)	0.2 (0.15-0.3)	0.25 (0.2-0.35)
					0.08 (0.05-0.15)	0.1 (0.08-0.15)	0.12 (0.08-0.2)
					0.08 (0.05-0.15)	0.12 (0.08-0.18)	0.15 (0.1-0.25)
M	Stainless Steel (Ferrite, Martensite)	≤HB270	NS4115 NS4125	140 (120-180)	0.18 (0.1-0.25)	0.25 (0.1-0.35)	0.3 (0.1-0.45)
					0.08 (0.05-0.15)	0.1 (0.08-0.15)	0.12 (0.08-0.2)
					0.08 (0.05-0.15)	0.12 (0.08-0.18)	0.15 (0.1-0.25)
	Stainless Steel (Austenite, Diphasic)	≤HB270	NS4115 NS4125	120 (100-160)	0.15 (0.1-0.25)	0.2 (0.1-0.35)	0.25 (0.1-0.45)
					0.08 (0.05-0.15)	0.1 (0.08-0.15)	0.12 (0.08-0.2)
					0.08 (0.05-0.15)	0.12 (0.08-0.18)	0.15 (0.1-0.25)
K	Grey Cast Iron	≤HB280	NS4115 NS4125	180 (150-220)	0.18 (0.1-0.25)	0.25 (0.1-0.35)	0.3 (0.1-0.45)
					0.08 (0.05-0.15)	0.1 (0.08-0.15)	0.12 (0.08-0.2)
					0.08 (0.05-0.15)	0.12 (0.08-0.18)	0.15 (0.1-0.25)
	Nodular Cast Iron Vermicular Cast Iron	≤HB350	NS4115 NS4125	120 (100-180)	0.15 (0.1-0.25)	0.2 (0.1-0.35)	0.25 (0.1-0.45)
					0.08 (0.05-0.15)	0.1 (0.08-0.15)	0.12 (0.08-0.2)
					0.08 (0.05-0.15)	0.12 (0.08-0.18)	0.15 (0.1-0.25)
S	Heat-resistant Alloy and Titanium Alloy	HRC25-35	NS4115 NS4125	40 (30-60)	0.1 (0.05-0.15)	0.12 (0.08-0.2)	0.15 (0.1-0.25)
					0.08 (0.05-0.15)	0.1 (0.08-0.2)	0.12 (0.08-0.2)
					0.1 (0.05-0.15)	0.12 (0.08-0.2)	0.15 (0.1-0.25)
N	Aluminum Alloy	HB60-210	NN9115	500 (200-900)	0.15 (0.1-0.25)	0.2 (0.15-0.3)	0.25 (0.2-0.35)

★ Tool RPM (min⁻¹) = (1000 X Cutting Speed) / (3.14 X Diameter of Cutter)

★ Workpiece Feed (mm/min) = Feed Per Tooth X Number Of Tooth X Tool RPM

Turning inserts

External turning

Internal turning

Grooving & parting

Threading

Milling

Boring & drilling

Tool holder

Solid carbide end mills

Solid carbide drill & taps

Technical information

Milling cutter

Two-side spiral blade 90 degree shoulder facing end mill — it is suitable for all kinds of plane, ladder, slotting machining, is in best efficiency and precision.

Main Characters

1. The inserts are in two-side and four-blade design, and they are thick and strong for deep milling process.
2. The design of swallow tail oblique trough, combined with insert repairing blade, could satisfy milling process for high finishing surface requirement.
3. Cutters adopt to orthogonal screw clamp to ensure higher clamp rigidity and safety.
4. Cutters' thick teeth design, combined with the design of low cutting resistance is a high process efficiency.
5. The model 06 thickness design could ensure the most cutting depth up to more than 10mm.
6. The diameter of cutter is from 40mm to 250mm, and it could cover the whole plane.

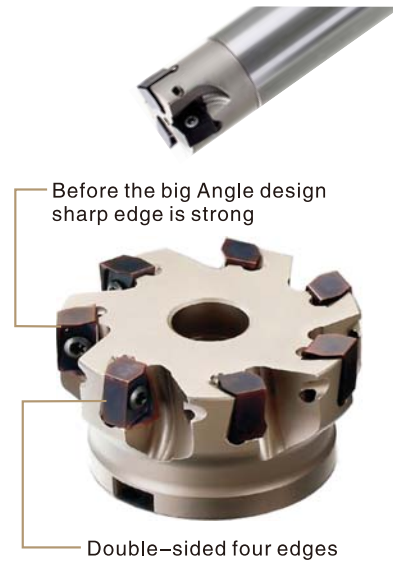

Case Study 1



Material Science	304 Stainless steel
Processing method	Slotting machining
Insert	ANMX080408-PDR-NS4125
Cutter head	BAN08-1616T2-160

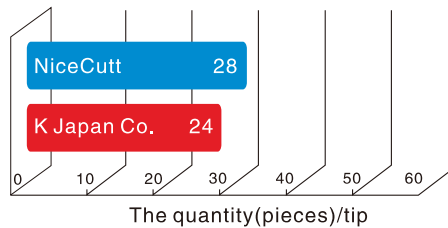

The cutting parameters
 $V_c=110\text{m/min}$
 $f_z=0.8\text{mm/t}$
 $a_p=1.2\text{mm}$
 $a_e=16\text{mm}$

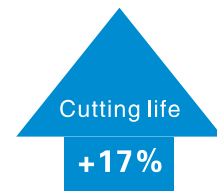

Case Study 2



Material Science	45# (HRC22)
Processing method	Face milling, dry cutting
Insert	ANMX160608-PDR-NS4125
Cutter head	BAN16D063T5-22

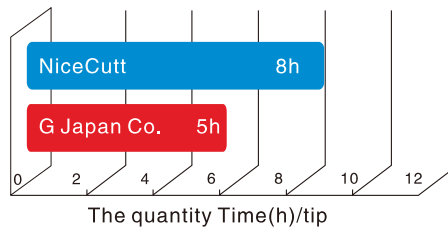

The cutting parameters
 $V_c=180\text{m/min}$
 $f=1.34\text{mm}$
 $a_p=1.5\text{mm}$
 $a_e=40\text{mm}$

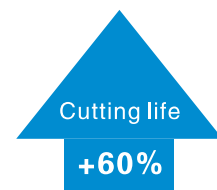

Two face spiral blade 4S degree face milling cutter

It is suitable for all kinds of plane process, and it is used for many places. And we provide goods in high quality at good price. It can clamp two kind of inserts to the same retaining nest. The inserts are the two-side square ones with 8 cutting edges and the two-side octagonal ones with 16 cutting edges

Main characters

- Orthogonal screw clamp could ensure better clamp rigidity and safety.
- Thick tooth design makes much higher efficiency.
- Square inserts could cut 5mm in depth at most, and the orthogonal ones 3mm.
- One cutter with two kinds of inserts is suitable for roughing, semi-finishing and finishing.
- It is very economical, with 8 cutting edges and 16 cutting edges.
- It has repairing light blade inserts, and could lead to high quality.
- The diameter of cutter is from 40mm to 315mm, and it could cover the whole plane.



Case Study 1



Material Science	HT300(HB230)
Processing method	Face milling, dry cutting
Insert	ONMU1205ANEN-NM-NS4125
Cutter head	SONFM45D080T06-27

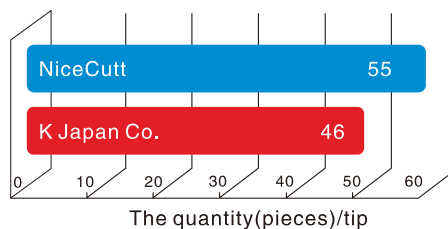

The cutting parameters
 $V_c=200\text{m/min}$
 $f_z=0.15\text{mm/t}$
 $a_p=3.5\text{mm}$
 $a_e=50\text{mm}$

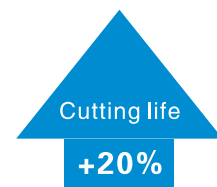

Case Study 2

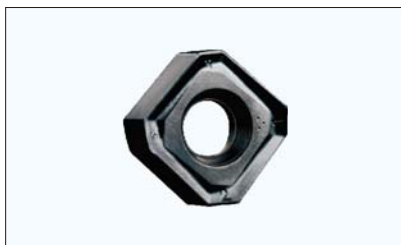

Material Science	45# (HRC22)
Processing method	Face milling, dry cutting
Insert	SNMU1205ANEN-NM-NS4125
Cutter head	SONFM45D080T06-27

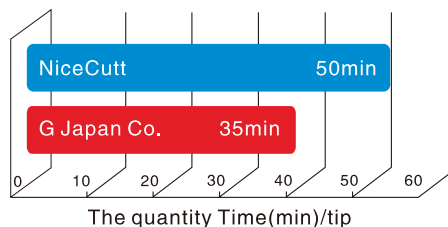

The cutting parameters
 $V_c=250\text{m/min}$
 $f_z=0.2\text{mm/t}$
 $a_p=2\text{mm}$
 $a_e=25\text{mm}$

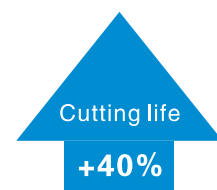

ODKT Insert

- The main angle is 43 DEG collocation type cutter body angle, ensuring quick cutting;
- The collocation excellent high universal brands: NS4115, NS4125; NN9115
- Is the most suitable for steel (P), stainless steel (M), iron (K), Aluminum Alloy (N) high economic face milling.

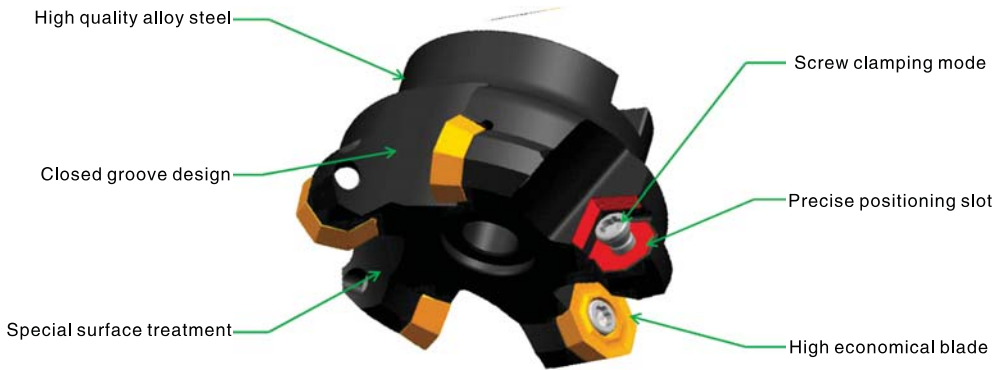

Case Study 1



Material Science	High temperature alloy steel (1.4839)
Processing method	Plane milling, finish machining
Insert	ODKT060508-NM-NS4125
Cutter head	FM45-D063T05-22-OD06

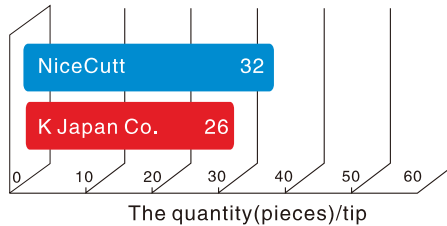

The cutting parameters
 $V_c=100\text{m/min}$
 $f_z=0.2\text{mm/t}$
 $a_p=1.5\text{mm}$
 $D=63\text{mm}$

Cutting life
+25%

Case Study 2



Material Science	45# (HRC22)
Processing method	Face milling, dry cutting
Insert	ONMU1205ANEN-NM-NS4125
Cutter head	SONFM45D080T06-27

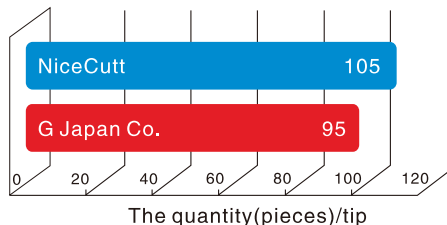

The cutting parameters
 $V_c=130\text{m/min}$
 $f_z=0.2\text{mm/t}$
 $a_p=0.3\text{mm}$
 $a_e=80\text{mm}$

Cutting life
+20%

TMR Milling Cutter

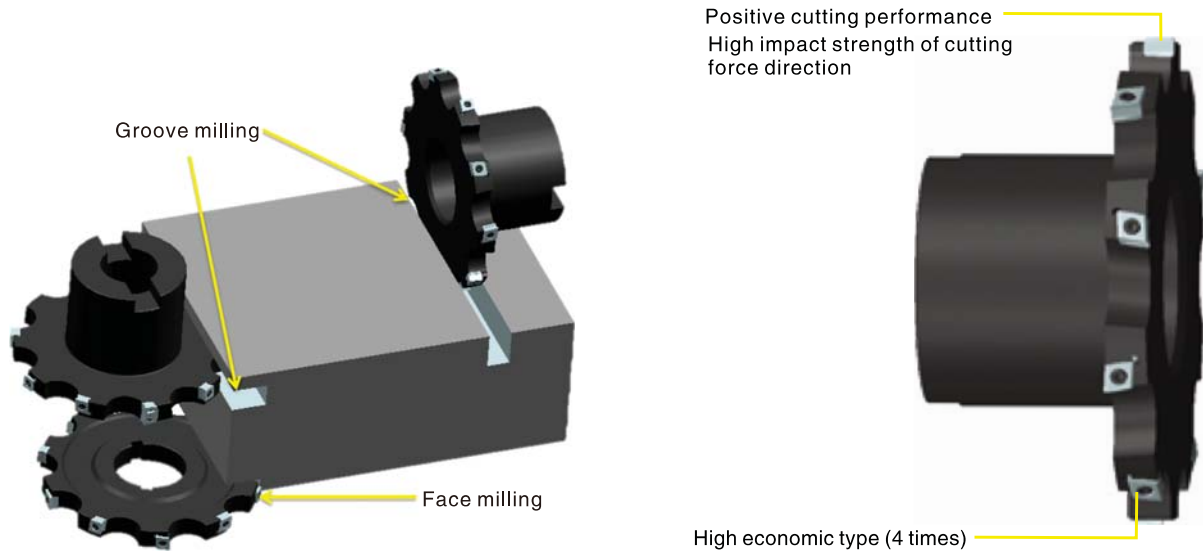

Case Study 1

Material Science	HT250 (HB180-230)
Processing method	Milling back
Insert	CNEU070508-NM-NS4125
Cutter head	TMR-080.H10.06T27-CN07

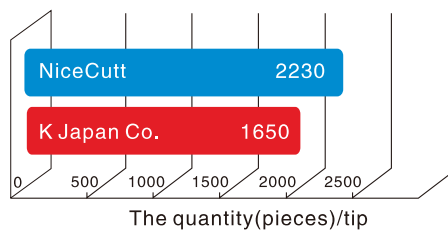

The cutting parameters
 $V_c=220\text{m/min}$
 $f_z=0.2\text{mm/t}$
 $a_p=3.5\text{mm}$
 $D=80\text{mm}$

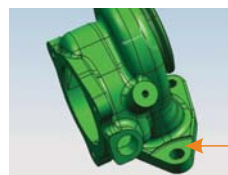

Cutting life
+35%

Case Study 2

Material Science	HT250
Processing method	Milling back
Insert	CNEU070508-NM-NS4125
Cutter head	TMR-125.H10.10T32-CN07

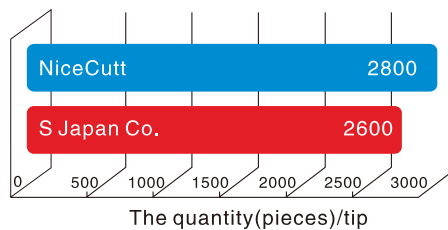

The cutting parameters
 $V_c=220\text{m/min}$
 $f_z=0.2\text{mm/t}$
 $a_p=15\text{mm}$
 $a_e=125\text{mm}$



Cutting life
+6%

Turning inserts

External turning

Internal turning

Grooving & parting

Threading

Milling

Boring & drilling

Tool holder

Solid carbide end mills

Solid carbide drill & taps

Technical information

Turning inserts

External turning

Internal turning

Grooving & parting

Threading

Milling

Boring & drilling

Tool holder

Solid carbide end mills

Solid carbide drill & taps

Technical information

APMT/APGT**



P170

ANMX



P170

SEEN/SEEX



P171

SPKN/SPER



P171

SPEN



P171

SEETPL**



P172

SEETPM**



P172

SEETPK**



P172

SEETPH**



P172

SEETPG**



P172

SEETPL**



P172

SEETPW**



P172

SNEUNL**



P173

SNEUNM**



P173

SNEUNW**



P173

SNMU



P173

ONMU



P173

ODKTNL**



P174

ODKTNM**



P174

ODKTNH**



P174

TPKN



P174

TPER



P174

RPET/RDETNL/NM**



P175~P176

RPEW/RDEW



P175~P176

<p>RCET**NE</p>  <p>P123</p>	<p>RDET**MH</p>  <p>P123</p>	<p>UDET</p>  <p>P124</p>	<p>UDMT</p>  <p>P123</p>
<p>CNEU</p>  <p>P177</p>	<p>HNMX/SNEX</p>  <p>P178</p>	<p>SNEX</p>  <p>P178</p>	<p>QOHX</p>  <p>P179</p>
<p>QPHT</p>  <p>P179</p>	<p>MFT</p>  <p>P180</p>	<p>T2139-P32**</p>  <p>P181</p>	<p>BAP/RP</p>  <p>P182</p>
<p>BFR</p>  <p>P183</p>	<p>BAP</p>  <p>P184~P185</p>	<p>BRP</p>  <p>P186~P187</p>	<p>BRD</p>  <p>P188~P189</p>
<p>DX45</p>  <p>P190</p>	<p>BTC</p>  <p>P190</p>	<p>TP</p>  <p>P191</p>	<p>BSC</p>  <p>P191</p>
<p>AJU</p>  <p>P192</p>	<p>ATS</p>  <p>P192</p>	<p>BUD</p>  <p>P193</p>	<p>BAP</p>  <p>P194</p>

Turning inserts

External turning

Internal turning

Grooving & parting

Threading

Milling

Boring & drilling

Tool holder

Solid carbide end mills

Solid carbide drill & taps

Technical information

Turning inserts

External turning

Internal turning

Grooving & parting

Threading

Milling

Boring & drilling

Tool holder

Solid carbide end mills

Solid carbide drill & taps

Technical information

BRP/BRD



P194~P195

BAN



P196

BAN



P196

SONFM



P197

TFM55°



P197

SE12 45°



P198

BSE45°



P198

SE13 45°



P199

FM



P199

BM90°



P200

BM90°



P200

BT



P201

HMC



P201

HMC



P202

TMR



P202

SMR



P203

STF



P203

STF



P203

BBMS



P204

APMT

Shoulder Milling Inserts

● continuous

◐ light Interruption

⊕ Interruption

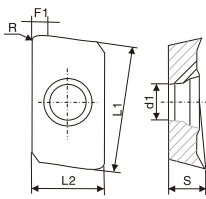

P	Steel	●	◐		●
M	Stainless Steel	●	◐		
K	Cast Iron	●	◐		
N	Non-ferrous Metal			●	
S	Heat-resistant Alloy, TiAlloy	●	◐		
H	High Hardness Materials				

Shape	Ordering Code	Dimensions(mm)						Coated-PVD		Uncoated	Cermet
		L1	L2	S	F1	d1	R	NS4115	NS4125	NN9115	NP115T
	APMT1135PDER-NL	10.83	6.16	3.50	1.92	2.80	0.80	○	●		
	APMT1604PDER-NL	16.26	9.26	4.76	2.00	4.60	0.80	●	●		
	APMT1135PDER-NM	10.83	6.16	3.50	1.92	2.80	0.80	●	●		○
	APMT1604PDER-NM	16.26	9.26	4.76	2.00	4.60	0.80	●	●		○
	APMT1135PDER-NR	10.83	6.16	3.50	1.92	2.80	0.80	●	●		○
	APMT1604PDER-NR	16.26	9.26	4.76	2.20	4.40	0.80	●	●		○
	APGT1135PDFR-AL	10.83	6.16	3.50	1.92	2.80	0.80			●	
	APGT1604PDFR-AL	16.26	9.26	4.76	2.20	4.40	0.80			●	

ANMX

Shoulder Milling Inserts

● continuous

◐ light Interruption

⊕ Interruption

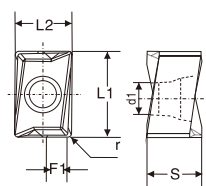

P	Steel	●	◐		
M	Stainless Steel	●	◐		
K	Cast Iron	●	◐		
N	Non-ferrous Metal				
S	Heat-resistant Alloy, TiAlloy	●	◐		
H	High Hardness Materials				

Shape	Ordering Code	Dimensions(mm)						Coated-PVD		Uncoated	Cermet
		L1	L2	S	F1	d1	R	NS4115	NS4125	NN9115	NP115T
	ANMX080404-PDR	8.60	6.60	5.20	2.50	3.50	0.40	○	○		
	ANMX080408-PDR	8.60	6.60	5.20	2.50	3.50	0.80	●	●		
	ANMX130508-PDR	13.70	10.00	8.90	3.40	4.40	0.80	●	●		
	ANMX130512-PDR	13.70	10.00	8.90	3.40	4.40	1.20	○	○		
	ANMX160608-PDR	16.70	11.20	10.40	4.70	5.40	0.80	●	●		
	ANMX160612-PDR	16.70	11.20	10.40	4.70	5.40	1.20	○	○		

● Stock ○ Available upon Order

Turning inserts

External turning

Internal turning

Grooving & parting

Threading

Milling

Boring & drilling

Tool holder

Solid carbide end mills

Solid carbide drill & taps

Technical information

SEEN SPKN SPEN

Face Milling Inserts

● continuous ● light Interruption ⊕ Interruption

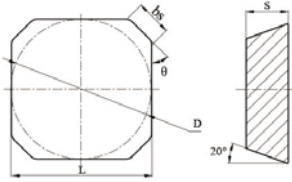

P	Steel	●	●		●
M	Stainless Steel	●	●		
K	Cast Iron	●	●	●	
N	Non-ferrous Metal				
S	Heat-resistant Alloy, TiAlloy	●	●		
H	High Hardness Materials				

Shape	Ordering Code	Dimensions(mm)					Coated-PVD		Uncoated	Cermet
		L	D	S	θ	bs	NS4115	NS4125	NN9115	NP115T
	SEEN1203AFTN	12.70	12.70	3.18	45°	2.30	○	○	○	○
	SEEN1204AFTN	12.70	12.70	4.76	45°	2.40	○	○	○	○
	SEEN1504AFTN	15.88	15.88	4.76	45°	2.40	○	○	○	○

Face Milling Inserts

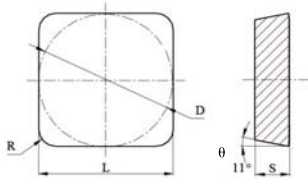

Shape	Ordering Code	Dimensions(mm)					Coated-PVD		Uncoated	Cermet
		L	D	S	θ	R	NS4115	NS4125	NN9115	NP115T
	SPKN1203EDR	12.70	12.70	3.18	15°	1.40	○	○	○	○
	SPKN1203EDL	12.70	12.70	3.18	15°	1.40	○	○	○	○
	SPKN1504EDR	15.88	15.88	4.76	15°	1.40	○	○	○	○
	SPKN1504EDL	15.88	15.88	4.76	15°	1.40	○	○	○	○

Face Milling Inserts

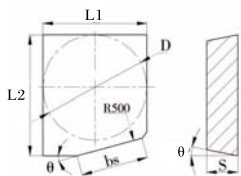

Shape	Ordering Code	Dimensions(mm)						Coated-PVD		Uncoated	Cermet
		L1	L2	D	S	θ	bs	NS4115	NS4125	NN9115	NP115T
	SPEN1504EDR-W	15.88	18.20	15.88	4.76	15°	10.20	○	○	○	○
	SPEN1504EDL-W	15.88	18.20	15.88	4.76	15°	10.20	○	○	○	○

● Stock ○ Available upon Order

Turning inserts

External turning

Internal turning

Grooving & parting

Threading

Milling

Boring & drilling

Tool holder

Solid carbide end mills

Solid carbide drill & taps

Technical information

SEET

Face Milling Inserts

● continuous

◐ light Interruption

⊕ Interruption

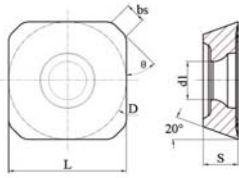

P	Steel	●	◐		●
M	Stainless Steel	●	◐		
K	Cast Iron	●	◐		
N	Non-ferrous Metal			●	
S	Heat-resistant Alloy, TiAlloy	●	◐		
H	High Hardness Materials				

Shape	Ordering Code	Dimensions(mm)						Coated-PVD		Uncoated	Cermet
		L	D	S	d1	θ	bs	NS4115	NS4125	NN9115	NP115T
	SEET1204AFEN-NL*	12.70	12.70	4.76	5.50	45°	2.50	●	○	○	○
	SEET1204AFEN-NL	12.70	12.70	4.76	5.50	45°	2.50			●	
	SEET13T3AGEN-NL	13.40	13.40	3.97	4.40	45°	1.70	●	●		○
	SEET13T3AGEN-NM	13.40	13.40	3.97	4.40	45°	1.20	●	●		
	SEET13T3AGSN-NK	13.40	13.40	3.97	4.40	45°	1.30	○	●		
	SEET13T3AGSN-NH	13.40	13.40	3.97	4.40	45°	1.30	○	●		
	SEET13T3AGSN-NG	13.40	13.40	3.97	4.40	45°	1.30	○	●		
	SEET13T3AGFN-AL	13.40	13.40	3.97	4.40	45°	2.20			●	
	SEET13T3AGEN-NW	7.69	13.40	3.97	4.40	45°	2.20	○	●		

● Stock ○ Available upon Order

Turning inserts

External turning

Internal turning

Grooving & parting

Threading

Milling

Boring & drilling

Tool holder

Solid carbide end mills

Solid carbide drill & taps

Technical information

SNEU

Face Milling Inserts

● continuous ◐ light Interruption ⊕ Interruption

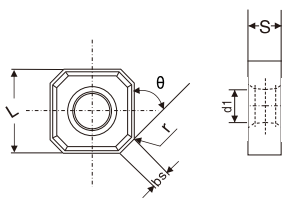

P	Steel	●	◐		
M	Stainless Steel	●	◐		
K	Cast Iron	●	◐		
N	Non-ferrous Metal			●	
S	Heat-resistant Alloy, TiAlloy	●	◐		
H	High Hardness Materials				

Shape	Ordering Code	Dimensions(mm)						Coated-PVD		Uncoated	Cermet
		L	S	d1	θ	bs	R	NS4115	NS4125	NN9115	NP115T
	SNEU1205ANEN-NL	12.70	6.35	6.00	45°	2.20	0.80	○	●		
	SNEU1205ANEN-NM	12.70	6.35	6.00	45°	2.20	0.80	○	●		
	SNEU1205ANFN-NL	12.70	6.35	6.00	45°	2.20	0.80			●	
	SNEU1205ANEN-NW	12.70	6.35	6.00	45°	5.60	0.80	●	●		
	SNMU1205ANER-NM	12.90	5.50	6.00	45°	3.00	0.50	●	●		

ONMU

Face Milling Inserts

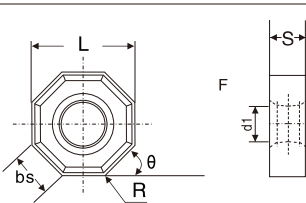

Shape	Ordering Code	Dimensions(mm)						Coated-PVD		Uncoated	Cermet
		L	S	d1	θ	bs	R	NS4115	NS4125	NN9115	NP115T

	ONMU1205ANEN-NM	12.90	5.50	6.00	45°	5.00	0.50	●	●		

● Stock ○ Available upon Order

Turning inserts

External turning

Internal turning

Grooving & parting

Threading

Milling

Boring & drilling

Tool holder

Solid carbide end mills

Solid carbide drill & taps

Technical information

ODKT TPKN

Face Milling Inserts

● continuous

◐ light Interruption

⊕ Interruption

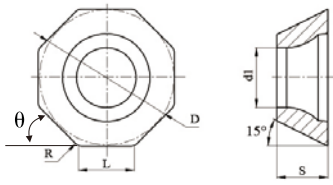

P	Steel	●	◐	
M	Stainless Steel	●	◐	
K	Cast Iron	●	◐	●
N	Non-ferrous Metal			●
S	Heat-resistant Alloy, TiAlloy	●	◐	
H	High Hardness Materials			

Shape	Ordering Code	Dimensions(mm)						Coated-PVD		Uncoated	Cermet
		L	D	S	d1	θ	R	NS4115	NS4125	NN9115	NP115T
	ODKT060508-NL	6.50	15.88	5.56	5.56	45°	0.80	○	●		
	ODKT060508-NM	6.50	15.88	5.56	5.56	45°	0.80	○	●		
	ODKT060508-NR	6.50	15.88	5.56	5.56	45°	0.80	○	●		
	ODKT060508-NL	6.50	15.88	5.56	5.56	45°	0.80			●	

Face Milling Inserts

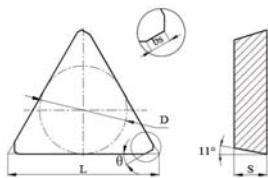

Shape	Ordering Code	Dimensions(mm)					Coated-PVD		Uncoated	Cermet
		L	D	S	θ	bs	NS4115	NS4125	NN0115	NP115T
	TPKN1603PDR	16.50	9.53	3.18	30°	1.30			●	
	TPKN2204PDR	22.00	12.70	4.76	30°	1.40			●	
	TPER1603PDTR-NR	16.50	9.53	3.18	30°	1.30			●	

● Stock ○ Available upon Order

Turning inserts

External turning

Internal turning

Grooving & parting

Threading

Milling

Boring & drilling

Tool holder

Solid carbide end mills

Solid carbide drill & taps

Technical information

RPET/RPEW/RCET

Profiling Milling Inserts

● continuous

● light Interruption

⊕ Interruption

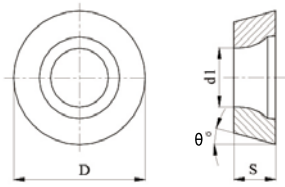

P	Steel	●	●		
M	Stainless Steel	●	●		
K	Cast Iron	●	●		
N	Non-ferrous Metal				
S	Heat-resistant Alloy, TiAlloy	●	●		
H	High Hardness Materials				

Shape	Ordering Code	Dimensions(mm)				Coated-PVD		Uncoated	Cermet
		D	S	d1	θ	NS4115	NS4125	NN9115	NP115T
	RPET1003M0-NL	10.00	3.18	4.40	11°	○	●		
	RPET1204M0-NL	12.00	4.76	4.40	11°	○	●		
	RPET08T2M0-NM	8.00	2.78	2.94	11°	○	○		
	RPET1003M0T-NM	10.00	3.18	4.40	11°	○	●		
	RPMT1003M0T-NM	10.00	3.18	4.40	11°	●	●		
	RPET1204M0-NM	12.00	4.76	4.40	11°	●	●		
	RPMT1204M0-NM	12.00	4.76	4.40	11°	○	●		
	RPET1606M0T-MM	16.00	6.35	5.50	11°	○	●		
	RPEW08T2M0	8.00	2.78	2.94	11°	○	○		
	RPEW1003M0	10.00	3.18	4.40	11°	○	●		
	RPEW10T3M0	10.00	3.18	4.40	11°	○	●		
	RPMW10T3M0	10.00	3.18	4.40	11°	●	●		
	RPEW1204M0T	12.00	4.76	4.40	11°	●	●		
	RPMW1204M0T	12.00	4.76	4.40	11°	●	●		
	RCET10T3M0-NE	10.00	3.97	4.40	7°	●	●		
	RCET1204M0-NE	12.00	4.76	4.00	7°	○	●		

● Stock ○ Available upon Order

Turning inserts

External turning

Internal turning

Grooving & parting

Threading

Milling

Boring & drilling

Tool holder

Solid carbide end mills

Solid carbide drill & taps

Technical information

RDET/RDEW/RDMW

Profiling Milling Inserts

● continuous

◐ light Interruption

⊕ Interruption

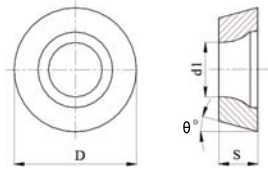

P	Steel	●	◐		
M	Stainless Steel	●	◐		
K	Cast Iron	●	◐		
N	Non-ferrous Metal				
S	Heat-resistant Alloy, TiAlloy	●	◐		
H	High Hardness Materials				

Shape	Ordering Code	Dimensions(mm)				Coated-PVD		Uncoated	Cermet
		D	S	d1	θ	NS4115	NS4125	NN9115	NP115T
	RDET0803M0-NL	8.00	3.18	2.94	15°	○	○		
	RDET10T3M0-NL	10.00	3.97	4.40	15°	○	●		
	RDET1204M0-NL	12.00	4.76	4.40	15°	○	●		
	RDET1604M0-NL	16.00	4.76	5.50	15°	○	●		
	RDET0802M0-NM*	8.00	2.38	2.94	15°	●			
	RDET0803M0-NM	8.00	3.18	2.94	15°	○	○		
	RDET10T3M0-NM	10.00	3.97	4.40	15°	●	●		
	RDMT10T3M0-NM	10.00	3.97	4.40	15°	●	●		
	RDET1204M0-NM	12.00	4.76	4.40	15°	●	●		
	RDMT1204M0-NM	12.00	4.76	4.40	15°	●	●		
	RDET1204M0T-NH	12.00	4.76	4.40	15°	●			
	RDMW1605MOT-NH	16.00	5.56	5.50	15°				
	RDEW0501M0	5.00	1.51	2.20	15°	●	○		
	RDEW0702M0T	7.00	2.38	2.80	15°	○	○		
	RDEW0803M0T	8.00	3.18	2.94	15°	●	○		
	RDEW10T3M0T	10.00	3.97	4.40	15°	●	●		
	RDEW1204M0T	12.00	4.76	4.40	15°	●	●		
	RDEW1604M0T	16.00	4.76	5.50	15°	●	●		

● Stock ○ Available upon Order

Turning inserts

External turning

Internal turning

Grooving & parting

Threading

Milling

Boring & drilling

Tool holder

Solid carbide end mills

Solid carbide drill & taps

Technical information

UDET/UDMT SDMT CNEU

Face Milling Inserts

● continuous

◐ light Interruption

⊕ Interruption

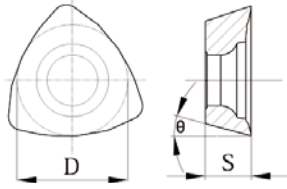

P	Steel	●	◐		
M	Stainless Steel	●	◐		
K	Cast Iron	●	◐		
N	Non-ferrous Metal				
S	Heat-resistant Alloy, TiAlloy	●	◐		
H	High Hardness Materials				

Shape	Ordering Code	Dimensions(mm)				Coated-PVD		Uncoated	Cermet
		D	S	d1	θ	NS4115	NS4125	NN9115	NP115T
	UDET080308-NM	6.80	3.18	2.94	15°	●	●		
	UDET12T312-NM	9.60	3.97	4.40	15°	●	●		
	UDMT080308T-NH	6.80	3.18	2.94	15°	●	●		
	UDMT12T312T-NH	9.60	3.97	4.40	15°	●	●		

Face Milling Inserts

● continuous

◐ light Interruption

⊕ Interruption

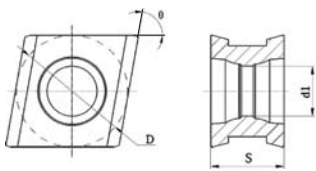

P	Steel	●	◐		
M	Stainless Steel	●	◐		
K	Cast Iron	●	◐		
N	Non-ferrous Metal				
S	Heat-resistant Alloy, TiAlloy	●	◐		
H	High Hardness Materials				

Shape	Ordering Code	Dimensions(mm)					Coated-PVD		Uncoated	Cermet
		D	S	d1	θ	R	NS4115	NS4125	NN9115	NP115T
	CNEU070508-NM	7.60	5.00	3.40	80°	0.80	○	●		

● Stock ○ Available upon Order

Turning inserts

External turning

Internal turning

Grooving & parting

Threading

Milling

Boring & drilling

Tool holder

Solid carbide end mills

Solid carbide drill & taps

Technical information

HNMX SNEX

Face Milling Inserts

		● continuous		◐ light Interruption		⊕ Interruption					
	P	Steel				●	◐	●	◐		
	M	Stainless Steel						●	◐		
	K	Cast Iron						●	◐		
	N	Non-ferrous Metal									
	S	Heat-resistant Alloy, TiAlloy						●	◐		
	H	High Hardness Materials									
Shape	Ordering Code	Dimensions(mm)						Coated-CVD		Coated-PVD	
		L	D	S	d1	θ	R	NP1115	NP1225	NS4115	NS4125
	HNMX050410-NM	7.10	12.70	5.00	5.00	55°	1.00	○	○	○	●

SNEX

Shoulder Milling Inserts

		● continuous		◐ light Interruption		⊕ Interruption			
	P	Steel				●	◐	●	◐
	M	Stainless Steel						●	◐
	K	Cast Iron						●	◐
	N	Non-ferrous Metal							
	S	Heat-resistant Alloy, TiAlloy						●	◐
	H	High Hardness Materials							
Shape	Ordering Code	Dimensions(mm)				Coated-CVD		Coated-PVD	
		D	L	S	d1	NP1115	NP1225	NS4115	NS4125
	SNEX1202-GM	12.70	12.70	2.30	5.00	○	●	○	●
	SNEX1203-GM	12.70	12.70	3.00	5.00	○	●	○	●
	SNEX12T3-GM	12.70	12.70	3.50	5.00	○	●	○	●
	SNEX1204-GM	12.70	12.70	4.00	5.00	○	●	○	●
	SNEX12T4-GM	12.70	12.70	4.50	5.00	○	●	○	●

● Stock ○ Available upon Order

Turning inserts

External turning

Internal turning

Grooving & parting

Threading

Milling

Boring & drilling

Tool holder

Solid carbide end mills

Solid carbide drill & taps

Technical information

QOHX

Shoulder Milling Inserts

● continuous

◐ light Interruption

⊕ Interruption

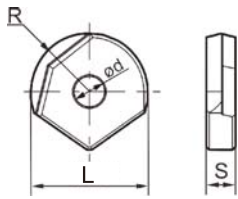

P	Steel				●
M	Stainless Steel				◐
K	Cast Iron				⊕
N	Non-ferrous Metal				
S	Heat-resistant Alloy, TiAlloy				◐
H	High Hardness Materials				

Shape	Ordering Code	Dimensions(mm)				Coated-CVD		Coated-PVD	
		L	S	d	R	NP1115	NP1125	NS4115	NS4125
	P3201-D10	10.00	3.00	4.00	5.00				●
	P3201-D12	12.00	3.00	4.00	6.00				●
	P3201-D16	16.00	4.00	5.00	8.00				●
	P3201-D20	20.00	5.00	5.00	10.00				●
	P3201-D25	25.00	6.00	6.00	12.50				●
	P3201-D32	32.00	7.00	8.00	16.00				●

QPHT

Face Milling Inserts

● continuous

◐ light Interruption

⊕ Interruption

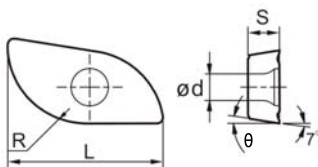

P	Steel					●
M	Stainless Steel					◐
K	Cast Iron					⊕
N	Non-ferrous Metal					
S	Heat-resistant Alloy, TiAlloy					◐
H	High Hardness Materials					

Shape	Ordering Code	Dimensions(mm)					Coated-CVD		Coated-PVD	
		L	R	S	d1	θ	NP1115	NP1125	NS4115	NS4125
	ZCEW100CE	20.00	10.00	3.97	4.00	11°				●
	ZCEW100SE	20.00	10.00	3.97	4.00	11°				●
	ZCEW125CE	25.00	12.50	4.76	4.70	11°				●
	ZCEW125SE	25.00	12.50	4.76	4.70	11°				●
	ZCEW150CE	30.00	15.00	6.35	5.80	11°				●
	ZCEW150SE	30.00	15.00	6.35	5.80	11°				●
	ZCEW160CE	32.00	16.00	6.35	5.80	11°				●
	ZCEW160SE	32.00	16.00	6.35	5.80	11°				●

● Stock ○ Available upon Order

Turning inserts

External turning

Internal turning

Grooving & parting

Threading

Milling

Boring & drilling

Tool holder

Solid carbide end mills

Solid carbide drill & taps

Technical information

MFT Anti vibration milling tool bar series

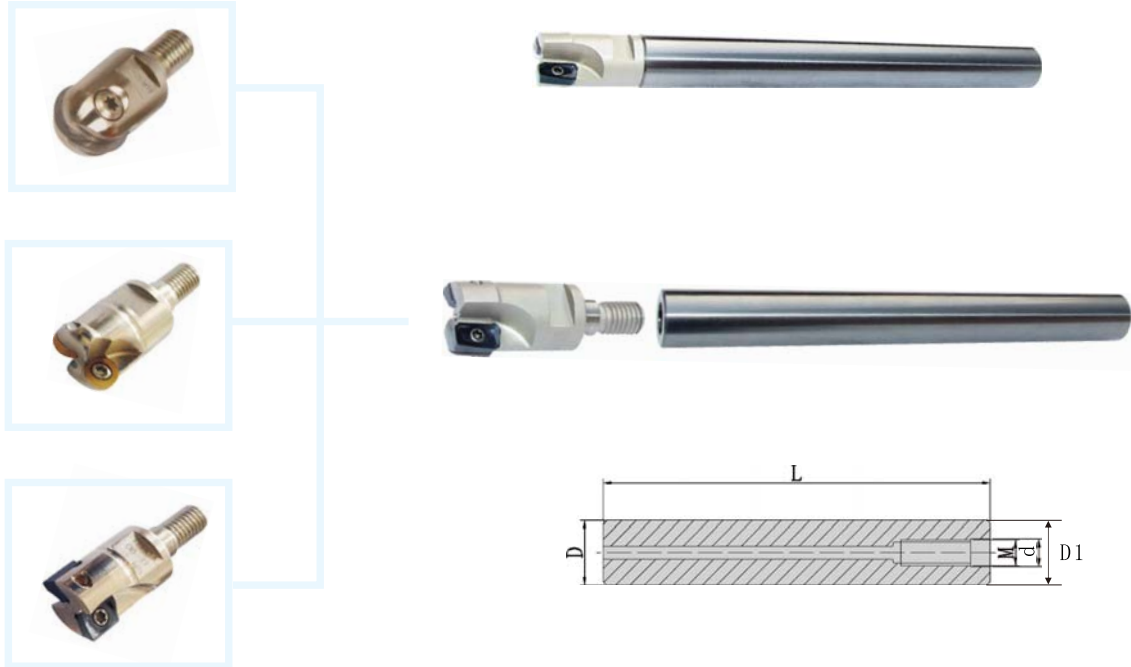

Ordering Code	Stock	Dimensions(mm)				
		D	D1	L	M	d
MFT10-10-100-M5	●	10	10	100	M5	5.5
MFT10-10-150-M5	●	10	10	150	M5	5.5
MFT12-12-100-M6	●	12	12	100	M6	6.5
MFT12-12-150-M6	●	12	12	150	M6	6.5
MFT12-12-200-M6	●	12	12	200	M6	6.5
MFT16-16-100-M8	●	16	16	100	M8	8.5
MFT16-16-150-M8	●	16	16	150	M8	8.5
MFT16-16-200-M8	●	16	16	200	M8	8.5
MFT20-20-150-M10	●	20	20	100	M10	10.5
MFT20-20-200-M10	●	20	20	150	M10	10.5
MFT20-20-250-M10	●	20	20	200	M10	10.5
MFT25-25-150-M12	●	25	25	150	M12	12.5
MFT25-25-200-M12	●	25	25	200	M12	12.5
MFT25-25-250-M12	●	25	25	250	M12	12.5
MFT25-25-300-M12	●	25	25	300	M12	12.5
MFT32-32-150-M16	●	32	32	150	M16	17
MFT32-32-200-M16	●	32	32	200	M16	17
MFT32-32-250-M16	●	32	32	250	M16	17
MFT32-32-300-M16	●	32	32	300	M16	17
MFT32-32-400-M16	●	32	32	400	M16	17

● Stock ○ Available upon Order

Turning inserts

External turning

Internal turning

Grooving & parting

Threading

Milling

Boring & drilling

Tool holder

Solid carbide end mills

Solid carbide drill & taps

Technical information

BF Ball End,finish milling cutters(thread)

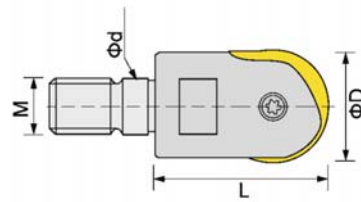

Ordering Code	Stock	Dimensions(mm)				Insert	Screw	Wrench
		D	d	L	M			
WGR10-M05	●	10	5.5	20	M5	P3202-D10	P32-M4	T-15
WGR12-M06	●	12	6.5	22	M6	P3202-D12	P32-M5	T-320
WGR16-M08	●	16	8.5	28	M8	P3202-D16		
WGR20-M10	●	20	10.5	30	M10	P3202-D20		
WGR25-M12	●	25	12.5	40	M12	P3202-D25	P32-M6	T-30
WGR32-M16	●	32	17.0	43	M16	P3202-D32	P32-M8	

BF Ball End,finish milling cutters

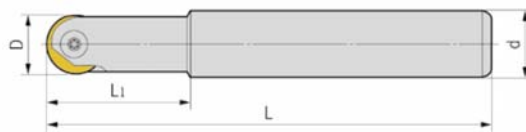

Ordering Code	Stock	Dimensions(mm)				Insert	Screw	Wrench
		D	d	L	L1			
T2139-5R-120-C10	●	10	10	130	30	P3202-D10	P32-M4	T-15
T2139-5R-150-C16	●	10	10	160	35			
T2139-6R-130-C12	●	12	12	130	30	P3202-D12	P32-M5	T20
T2139-6R-150-C12	●	12	12	160	30			
T2139-8R-130-C16	●	16	16	120	30	P3202-D16	P32-M5	T20
T2139-8R-150-C16	●	16	16	160	30			
T2139-8R-200-C16	●	16	16	200	45	P3202-D20	P32-M6	T30
T2139-10R-150-C20	●	20	20	160	30			
T2139-10R-200-C20	●	20	20	200	35	P3202-D25	P32-M6	T30
T2139-12.5R-150-C25	●	25	25	160	35			
T2139-12.5R-200-C25	●	25	25	200	40	P3202-D32	P32-M8	T30
T2139-12.5R-250-C25	●	25	25	250	60			
T2139-16R-200-C32	●	32	32	200	55	P3202-D32	P32-M8	T30
T2139-16R-250-C32	●	32	32	250	70			
T2139-16R-300-C32	●	32	32	300	80			

● Stock ○ Available upon Order

Turning inserts

External turning

Internal turning

Grooving & parting

Threading

Milling

Boring & drilling

Tool holder

Solid carbide end mills

Solid carbide drill & taps

Technical information

BAP Shoulder milling cutters

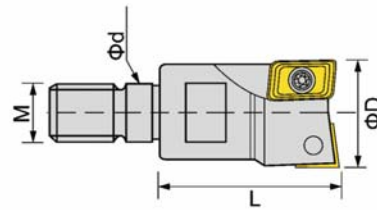

Ordering Code	Stock	Dimensions(mm)				Insert	Screw	Wrench
		D	d	L	M			
BAP3-16-2T-M08	●	16	8.5	25	M8	AP**1135	M2.5*6	T-8
BAP3-17-2T-M08	●	17	8.5	25	M8			
BAP3-20-2T-M10	●	20	10.5	30	M10			
BAP3-21-3T-M10	●	21	10.5	30	M10			
BAP3-25-3T-M12	●	15	12.5	35	M12			
BAP3-26-2T-M12	●	26	12.5	35	M12			
BAP4-25-2T-M12	●	25	12.5	35	M12	AP**1604	M4*10	T-15
BAP4-32-3T-M16	●	32	17	43	M16			
BAP4-35-3T-M16	●	35	17	43	M16			

RP Corner radius milling cutters

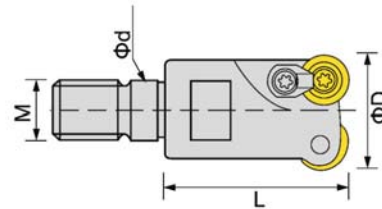

Ordering Code	Stock	Dimensions(mm)				Insert	Screw	Wrench
		D	d	L	M			
RD0802-20-2T-M10	●	20	10.5	32	M10	RD**0802	M2.5*6	T-8
RD0802-21-2T-M10	●	21	10.5	32	M10			
RP1003-25-2T-M12	●	25	12.5	35	M12	RP**1003	M3.5*8	T-15
RP1003-26-2T-M12	●	26	12.5	35	M12			
RP1003-30-3T-M12	●	30	12.5	35	M12			
RP1003-32-3T-M16	●	32	17	43	M16			
RP1003-35-3T-M16	●	35	17	43	M16			

● Stock ○ Available upon Order

Turning inserts

External turning

Internal turning

Grooving & parting

Threading

Milling

Boring & drilling

Tool holder

Solid carbide end mills

Solid carbide drill & taps

Technical information

BFR Ball End, milling bar

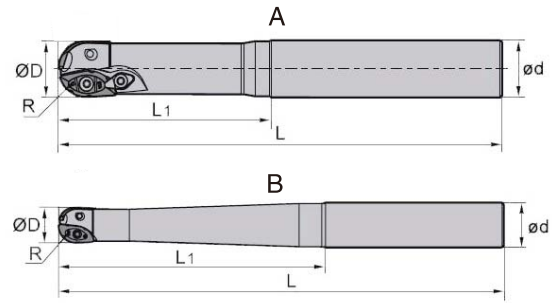

Ordering Code	Stock	Dimensions(mm)				Fig	Insert	Screw	Screw	Wrench
		D	d	L	L1					
BCF-10R-150-C20	●	20	20	150	70	A	ZCEW100CE	---	M2.5*6	T-7
BCF-10R-200-C25	●	20	25	200	100	B	ZCEW100SE	---	M3*8	T-10
BCF-10R-250-C25	●	20	25	250	150					
BCF-12.5R-150-C25	●	25	25	150	80	A	ZCEW125CE	---	M4*11	T-15
BCF-12.5R-200-C25	●	25	25	200	100					
BCF-12.5R-250-C25	●	25	25	250	110	B	ZCEW125SE	---	M4*11	T-15
BCF-12.5R-300-C32	●	25	32	300	120					
BCF-15R-160-C32	●	30	32	160	70					
BCF-15R-200-C32	●	30	32	200	100	B	ZCEW150CE	---	M4*11	T-15
BCF-15R-250-C32	●	30	32	250	120					
BCF-15R-300-C32	●	30	32	300	150	A	ZCEW150SE	---	M5*13	T-20
BCF-16R-160-C32	●	32	32	160	70					
BCF-16R-200-C32	●	32	32	200	100					
BCF-16R-250-C32	●	32	32	250	120					
BCF-16R-300-C32	●	32	32	300	150		ZCEW160CE	---	M4*11	T-15
							ZCEW160SE	---	M5*13	T-20

Ordering Code	Stock	Dimensions(mm)				Fig	Insert	Screw	Screw	Wrench
		D	d	L	L1					
BCFL-10R-150-C20	●	20	20	150	70	A	ZCEW100CE	---	M2.5*6	T-7
BCFL-10R-200-C25	●	20	25	200	100	B	ZCEW100SE	---	M3*8	T-10
BCFL-10R-250-C25	●	20	25	250	150					
BCFL-12.5R-150-C25	●	25	25	150	80	A	ZCEW125CE	---	M4*11	T-15
BCFL-12.5R-200-C25	●	25	25	200	100					
BCFL-12.5R-250-C25	●	25	25	250	110					
BCFL-12.5R-300-C32	●	25	32	300	120	B	CPMT090308	---	M4*11	T-15
BCFL-15R-160-C32	●	30	32	160	70					
BCFL-15R-200-C32	●	30	32	200	100					
BCFL-15R-250-C32	●	30	32	250	120	B	ZCEW150CE	---	M4*11	T-15
BCFL-15R-300-C32	●	30	32	300	150					
BCFL-16R-160-C32	●	32	32	160	70	A	ZCEW150SE	---	M5*13	T-20
BCFL-16R-200-C32	●	32	32	200	100					
BCFL-16R-250-C32	●	32	32	250	120					
BCFL-16R-300-C32	●	32	32	300	150		ZCEW160CE	---	M4*11	T-15
							ZCEW160SE	---	M5*13	T-20
							CPMT090308	---	M5*13	T-20

● Stock ○ Available upon Order

BAP Straight shank milling cutter BAP series

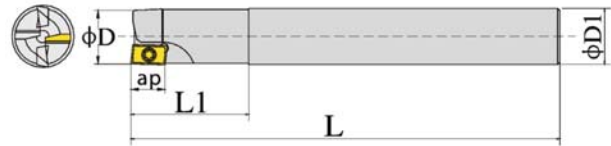

Ordering Code	Stock	Dimensions(mm)					Insert	Screw	Wrench
		D	D1	L	Z	ap			
BAP300R-10-1T-10-120	●	10	10	120	1	9	AP**1135	M2.5*6	T-8
BAP300R-12-1T-12-120	●	12	12	120					
BAP300R-16-2T-16-120	●	16	16	120					
BAP300R-16-2T-16-150	●	16	16	150					
BAP300R-16-2T-16-160	●	16	16	160					
BAP300R-16-2T-16-200	●	16	16	200					
BAP300R-20-2T-20-120	●	20	20	120					
BAP300R-20-2T-20-150	●	20	20	150					
BAP300R-20-2T-20-160	●	20	20	160					
BAP300R-20-2T-20-200	●	20	20	200					
BAP300R-25-3T-25-120	●	25	25	120	3				
BAP300R-25-3T-25-150	●	25	25	150					
BAP300R-25-3T-25-160	●	25	25	160					
BAP300R-25-3T-25-200	●	25	25	200					
BAP300R-32-3T-32-160	●	32	32	160					
BAP300R-32-3T-32-200	●	32	32	200					
BAP300R-32-3T-32-250	●	32	32	250					
BAP400R-25-2T-25-120	●	25	25	120	2	14	AP**1604	M4*10	T-15
BAP400R-25-2T-25-150	●	25	25	150					
BAP400R-25-2T-25-160	●	25	25	160					
BAP400R-25-2T-25-200	●	25	25	200					
BAP400R-25-2T-25-250	●	25	25	250					
BAP400R-32-2T-32-160	●	32	32	160					
BAP400R-32-2T-32-200	●	32	32	200					
BAP400R-32-2T-32-250	●	32	32	250					

● Stock ○ Available upon Order

Turning inserts

External turning

Internal turning

Grooving & parting

Threading

Milling

Boring & drilling

Tool holder

Solid carbide end mills

Solid carbide drill & taps

Technical information

BAP Variable Head, mills BAP series

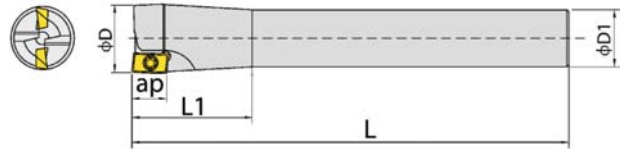

Turning inserts

External turning

Internal turning

Grooving & parting

Threading

Milling

Boring & drilling

Tool holder

Solid carbide end mills

Solid carbide drill & taps

Technical information

Ordering Code	Stock	Dimensions(mm)					Insert	Screw	Wrench			
		D	D1	L	Z	ap						
BAP300R-17-2T-16-120	●	17	16	120	2	9	AP**1135	M2.5*6	T-8			
BAP300R-17-2T-16-150	●	17	16	150								
BAP300R-17-2T-16-160	●	17	16	160								
BAP300R-17-2T-16-200	●	17	16	200								
BAP300R-21-2T-20-120	●	21	20	120								
BAP300R-21-2T-20-150	●	21	20	150								
BAP300R-21-2T-20-160	●	21	20	160								
BAP300R-21-2T-20-200	●	21	20	200								
BAP300R-26-3T-25-120	●	26	25	120	3	9	M2.5*6	T-8				
BAP300R-26-3T-25-150	●	26	25	150								
BAP300R-26-3T-25-160	●	26	25	160								
BAP300R-26-3T-25-200	●	26	25	200								
BAP300R-26-3T-25-250	●	26	25	250								
BAP300R-32-3T-25-120	●	32	25	120								
BAP300R-32-3T-25-150	●	32	25	150								
BAP300R-32-3T-25-160	●	32	25	160								
BAP300R-32-3T-25-200	●	32	25	200	2	14	M4*10	T-15				
BAP300R-32-3T-25-250	●	32	25	250								
BAP300R-35-3T-32-160	●	35	32	160								
BAP300R-35-3T-32-200	●	35	32	200								
BAP300R-35-3T-32-250	●	35	32	250								
BAP400R-26-2T-25-120	●	26	25	120					3	AP**1604	M4*10	T-15
BAP400R-26-2T-25-150	●	26	25	150								
BAP400R-26-2T-25-160	●	26	25	160								
BAP400R-26-2T-25-200	●	26	25	200								
BAP400R-26-2T-25-250	●	26	25	250								
BAP400R-32-2T-25-160	●	32	25	160								
BAP400R-32-2T-25-200	●	32	25	200								
BAP400R-32-2T-25-250	●	32	25	250								
BAP400R-35-3T-32-160	●	35	32	160	3	AP**1604	M4*10	T-15				
BAP400R-35-3T-32-200	●	35	32	200								
BAP400R-35-3T-32-250	●	35	32	250								

● Stock ○ Available upon Order

BRP Straight shank milling cutter BRP series

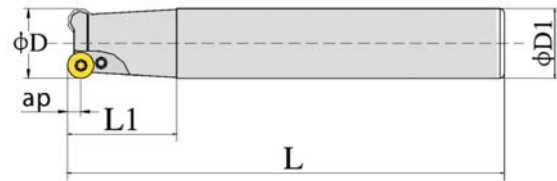

Ordering Code	Stock	Dimensions(mm)					Insert	Screw	Wrench	Clamp
		D	D1	L	Z	ap				
BRP4R-16-2T-16-120	●	16	16	120	2	4	RP**08T2	M3.0*6	T-10	R4YD
BRP4R-16-2T-16-150	●	16	16	150						
BRP4R-16-2T-16-160	●	16	16	160						
BRP4R-16-2T-16-200	●	16	16	200						
BRP4R-20-2T-20-120	●	20	20	120						
BRP4R-20-2T-20-150	●	20	20	150						
BRP4R-20-2T-20-160	●	20	20	160						
BRP4R-20-2T-20-200	●	20	20	200						
BRP4R-25-3T-25-120	●	25	25	120	3	5	RP**10T3	M3.5*8	T-15	R5YD
BRP4R-25-3T-25-150	●	25	25	150						
BRP4R-25-3T-25-160	●	25	25	160						
BRP4R-25-3T-25-200	●	25	25	200						
BRP5R-16-1T-16-120	●	16	16	120	1	5	RP**10T3	M3.5*8	T-15	R5YD
BRP5R-16-1T-16-160	●	16	16	160						
BRP5R-16-1T-16-200	●	16	16	200						
BRP5R-20-1T-20-120	●	20	20	120						
BRP5R-20-1T-20-160	●	20	20	160						
BRP5R-20-1T-20-200	●	20	20	200						
BRP5R-25-2T-25-120	●	25	25	120	2	6	RP**1204	M4.0*10	T-15	R6YD
BRP5R-25-2T-25-160	●	25	25	160						
BRP5R-25-2T-25-200	●	25	25	200						
BRP5R-25-2T-25-250	●	25	25	250						
BRP5R-32-3T-32-160	●	32	32	160	3	6	RP**1204	M4.0*10	T-15	R6YD
BRP5R-32-3T-32-200	●	32	32	200						
BRP5R-32-3T-32-250	●	32	32	250						
BRP6R-25-2T-25-160	●	25	25	160	2	6	RP**1204	M4.0*10	T-15	R6YD
BRP6R-25-2T-25-200	●	25	25	200						
BRP6R-25-2T-25-250	●	25	25	250	3	6	RP**1204	M4.0*10	T-15	R6YD
BRP6R-32-3T-32-160	●	32	32	160						
BRP6R-32-3T-32-200	●	32	32	200						
BRP6R-32-3T-32-250	●	32	32	250						

● Stock ○ Available upon Order

Turning inserts

External turning

Internal turning

Grooving & parting

Threading

Milling

Boring & drilling

Tool holder

Solid carbide end mills

Solid carbide drill & taps

Technical information

BRP Mills, variable head BRP series

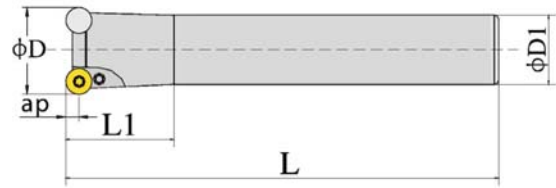

Ordering Code	Stock	Dimensions(mm)					Insert	Screw	Wrench	Clamp
		D	D1	L	Z	ap				
BRP4R-17-2T-16-120	●	17	16	120	2	4	RP**08T2	M3.0*6	T-10	R4YD
BRP4R-17-2T-16-160	●	17	16	160						
BRP4R-17-2T-16-200	●	17	16	200						
BRP4R-21-2T-20-120	●	21	20	120						
BRP4R-21-2T-20-160	●	21	20	160						
BRP4R-21-2T-20-200	●	21	20	200						
BRP4R-26-3T-25-120	●	26	25	120	3					
BRP4R-26-3T-25-160	●	26	25	160						
BRP4R-26-3T-25-200	●	26	25	200						
BRP5R-17-1T-16-120	●	17	16	120	1					
BRP5R-17-1T-16-160	●	17	16	160						
BRP5R-17-1T-16-200	●	17	16	200						
BRP5R-21-1T-20-120	●	21	20	120						
BRP5R-21-1T-20-160	●	21	20	160						
BRP5R-21-1T-20-200	●	21	20	200						
BRP5R-26-2T-25-120	●	26	25	120	2	5	RP**10T3	M3.5*8	T-15	R5YD
BRP5R-26-2T-25-160	●	26	25	160						
BRP5R-26-2T-25-200	●	26	25	200						
BRP5R-26-2T-25-250	●	26	25	250						
BRP5R-32-3T-25-160	●	32	25	160	3					
BRP5R-32-3T-25-200	●	32	25	200						
BRP5R-32-3T-25-250	●	32	25	250						
BRP5R-35-3T-32-160	●	35	32	160						
BRP5R-35-3T-32-200	●	35	32	200						
BRP5R-35-3T-32-250	●	35	32	250						
BRP6R-26-2T-25-160	●	26	25	160	2					
BRP6R-26-2T-25-200	●	26	25	200						
BRP6R-26-2T-25-250	●	26	25	250						
BRP6R-32-3T-25-160	●	32	25	160						
BRP6R-32-3T-25-200	●	32	25	200						
BRP6R-32-3T-25-250	●	32	25	250						
BRP6R-35-3T-32-160	●	35	32	160	3	6	RP**1204	M4.0*10	T-15	R6YD
BRP6R-35-3T-32-200	●	35	32	200						
BRP6R-35-3T-32-250	●	35	32	250						

●Stock ○Available upon Order

Turning inserts

External turning

Internal turning

Grooving & parting

Threading

Milling

Boring & drilling

Tool holder

Solid carbide end mills

Solid carbide drill & taps

Technical information

BRD Straight shank milling cutter BRD series

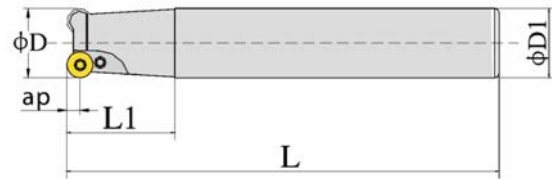

Ordering Code	Stock	Dimensions(mm)					Insert	Screw	Wrench	Clamp
		D	D1	L	Z	ap				
BRD4R-16-2T-16-120	●	16	16	120	2	4	RD**0802	M3.0*6	T-10	R4YD
BRD4R-16-2T-16-150	●	16	16	150						
BRD4R-16-2T-16-160	●	16	16	160						
BRD4R-16-2T-16-200	●	16	16	200						
BRD4R-20-2T-20-120	●	20	20	120						
BRD4R-20-2T-20-150	●	20	20	150						
BRD4R-20-2T-20-160	●	20	20	160						
BRD4R-20-2T-20-200	●	20	20	200						
BRD4R-25-3T-25-120	●	25	25	120	3					
BRD4R-25-3T-25-150	●	25	25	150						
BRD4R-25-3T-25-160	●	25	25	160						
BRD4R-25-3T-25-200	●	25	25	200						
BRD5R-16-1T-16-120	●	16	16	120	1					
BRD5R-16-1T-16-160	●	16	16	160						
BRD5R-16-1T-16-200	●	16	16	200						
BRD5R-20-1T-20-120	●	20	20	120						
BRD5R-20-1T-20-160	●	20	20	160						
BRD5R-20-1T-20-200	●	20	20	200						
BRD5R-25-2T-25-120	●	25	25	120	2	5	RD**10T3	M3.5*8	T-15	R5YD
BRD5R-25-2T-25-160	●	25	25	160						
BRD5R-25-2T-25-200	●	25	25	200						
BRD5R-25-2T-25-250	●	25	25	250						
BRD5R-32-3T-32-160	●	32	32	160	3					
BRD5R-32-3T-32-200	●	32	32	200						
BRD5R-32-3T-32-250	●	32	32	250						
BRD6R-25-2T-25-160	●	25	25	160	2	6	RD**1204	M4.0*10	T-15	R6YD
BRD6R-25-2T-25-200	●	25	25	200						
BRD6R-25-2T-25-250	●	25	25	250	3					
BRD6R-32-3T-32-160	●	32	32	160						
BRD6R-32-3T-32-200	●	32	32	200						
BRD6R-32-3T-32-250	●	32	32	250						

● Stock ○ Available upon Order

Turning inserts

External turning

Internal turning

Grooving & parting

Threading

Milling

Boring & drilling

Tool holder

Solid carbide end mills

Solid carbide drill & taps

Technical information

BRD Mills, variable head BRD series

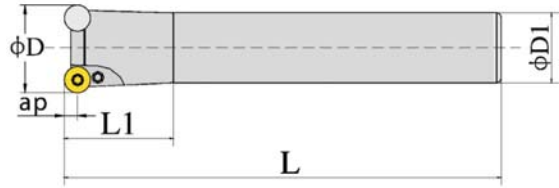

Ordering Code	Stock	Dimensions(mm)					Insert	Screw	Wrench	Clamp
		D	D1	L	Z	ap				
BRD4R-17-2T-16-120	●	17	16	120	2	4	RD**0802	M3.0*6	T-10	R4YD
BRD4R-17-2T-16-160	●	17	16	160						
BRD4R-17-2T-16-200	●	17	16	200						
BRD4R-21-2T-20-120	●	21	20	120						
BRD4R-21-2T-20-160	●	21	20	160						
BRD4R-21-2T-20-200	●	21	20	200						
BRD4R-26-3T-25-120	●	26	25	120	3					
BRD4R-26-3T-25-160	●	26	25	160						
BRD4R-26-3T-25-200	●	26	25	200						
BRD5R-17-1T-16-120	●	17	16	120	1					
BRD5R-17-1T-16-160	●	17	16	160						
BRD5R-17-1T-16-200	●	17	16	200						
BRD5R-21-1T-20-120	●	21	20	120						
BRD5R-21-1T-20-160	●	21	20	160						
BRD5R-21-1T-20-200	●	21	20	200						
BRD5R-26-2T-25-120	●	26	25	120	2	5	RD**10T3	M3.5*8	T-15	R5YD
BRD5R-26-2T-25-160	●	26	25	160						
BRD5R-26-2T-25-200	●	26	25	200						
BRD5R-26-2T-25-250	●	26	25	250	3					
BRD5R-32-3T-25-160	●	32	25	160						
BRD5R-32-3T-25-200	●	32	25	200						
BRD5R-32-3T-25-250	●	32	25	250						
BRD5R-35-3T-32-160	●	35	32	160						
BRD5R-35-3T-32-200	●	35	32	200						
BRD5R-35-3T-32-250	●	35	32	250	2					
BRD6R-26-2T-25-160	●	26	25	160						
BRD6R-26-2T-25-200	●	26	25	200						
BRD6R-26-2T-25-250	●	26	25	250						
BRD6R-32-3T-25-160	●	32	25	160						
BRD6R-32-3T-25-200	●	32	25	200						
BRD6R-32-3T-25-250	●	32	25	250	3	6	RD**1204	M4.0*10	T-15	R6YD
BRD6R-35-3T-32-160	●	35	32	160						
BRD6R-35-3T-32-200	●	35	32	200						
BRD6R-35-3T-32-250	●	35	32	250						

● Stock ○ Available upon Order

Turning inserts

External turning

Internal turning

Grooving & parting

Threading

Milling

Boring & drilling

Tool holder

Solid carbide end mills

Solid carbide drill & taps

Technical information

DX45 Pilot drill series



Ordering Code	Stock	Dimensions(mm)		Insert	Screw	Wrench
		D	L			
DX45-16-120	●	20	120	TCGT16T302	M4.0*10	T-15

B30TC Chamfer cutter BTC series

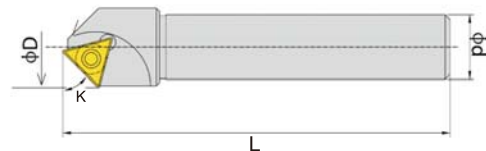

Ordering Code	Stock	Dimensions(mm)					Insert	Screw	Wrench
		D	d	L	Z	K			
B30TC11 20 1T20-120	●	20	20	120	1	30°	TC**1102	M2.5*6	T-8
B30TC11 25 2T20-120	●	25	20	120	2	30°			
B45TC11 20 1T20-120	●	20	20	120	1	45°			
B45TC11 25 2T20-120	●	25	20	120	2	45°			
B60TC11 20 1T20-120	●	20	20	120	1	60°			
B60TC11 25 2T20-120	●	25	20	120	2	60°			
B30TC16 20 1T20-120	●	20	20	120	1	30°	TC**16T3	M2.5*7	T-9
B30TC16 32 2T25-120	●	32	25	120	2	30°			
B45TC16 20 1T20-120	●	20	20	120	1	45°			
B45TC16 32 2T25-120	●	32	25	120	2	45°			
B60TC16 20 1T20-120	●	20	20	120	1	60°			
B60TC16 32 2T25-120	●	32	25	120	2	60°			

● Stock ○ Available upon Order

Turning inserts

External turning

Internal turning

Grooving & parting

Threading

Milling

Boring & drilling

Tool holder

Solid carbide end mills

Solid carbide drill & taps

Technical information

TP Chamfer cutter bar

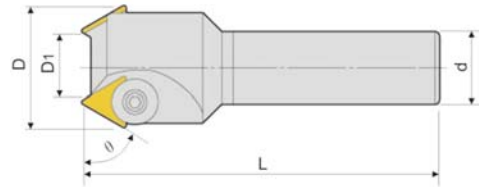

Ordering Code	Stock	Dimensions(mm)						Insert	Screw	Wrench
		D	D1	d	L	Z	K			
TP60-C25-40-120-2T	●	37.7	15.8	25	120	2	60°	TP**1603	M060H080	L4.0
TP45-C20-20-120-1T	●	20.4	4	20	120	1	45°			
TP45-C20-32-120-2T	●	30.2	12	20	120	2	45°			
TP45-C25-50-160-3T	●	49	24	25	160	3	45°	TP**2204	M080H120	L5.0
TP30-C25-40-120-2T	●	39	26	25	120	2	30°	TP**1603	M060H080	L4.0
TP30-C32-55-160-3T	●	54.5	36	32	160	3	30°	TP**2204	M080H120	L5.0

B45SC Chamfer cutter BSC series(Multi-purpose)

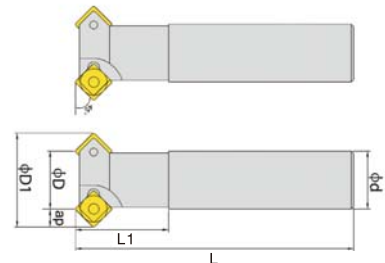

Ordering Code	Stock	Dimensions(mm)						Insert	Screw	Wrench
		D	D1	d	L	Z	K			
B45SC-09-1T20-120	●	9	22.6	20	120	1	45°	SC**09T3	M3.5*8	T-15
B45SC-19-2T20-120	●	19	32.1	20	120	2	45°			
B45SC-25-2T25-120	●	25	41.3	25	120	2	45°			

● Stock ○ Available upon Order

Turning inserts

External turning

Internal turning

Grooving & parting

Threading

Milling

Boring & drilling

Tool holder

Solid carbide end mills

Solid carbide drill & taps

Technical information

AJU Center drilling mills

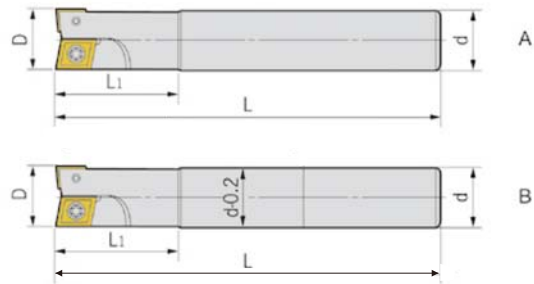

Ordering Code	Stock	Dimensions(mm)					Insert	Screw	Wrench
		D	d	L	L1	Z			
AJU-C16-16-120-2T	●	16	16	120	35	2	CCMT060204	M2.5*6	T-8
AJU-C16-16-150-2T	●	16	16	150	35		CPMT080204Z		
AJU-C16-16-200-2T	●	16	16	200	40				
AJU-C20-20-160-2T	●	20	20	160	50		CCMT060204	M2.5*6	T-8
AJU-C20-20-200-2T	●	20	20	200	60		CPMT090204Z	M3.5*8	T-15
AJU-C25-25-160-2T	●	25	25	160	60		CCMT090308	M4.0*8	T-15
AJU-C25-25-200-2T	●	25	25	200	70		CPMT120308Z		
AJU-C25-25-250-2T	●	25	25	250	80				
AJU-C32-32-200-2T	●	32	32	200	60		CPMT120408	M5.0*11	T-20
AJU-C32-32-250-2T	●	32	32	250	70		CPMT160408Z		

ATS T-Slot Milling cutter

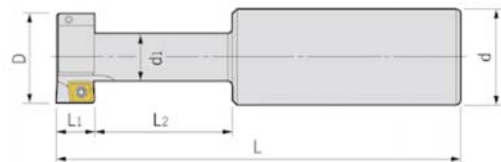

Ordering Code	Stock	Dimensions(mm)							Insert	Screw	Wrench
		D	d	d1	L	L1	I2				
ATS25-C25-120-2T-06	●	25	25	12.5	120	11	21	CCMT060204	M2.5*6	T-8	
ATS30-C25-120-4T-06	●	30	25	15	120	14	30	CCMT060204			
ATS32-C25-120-4T-08	●	32	25	16	120	14	30	CPMT080204	M4.0*8	T-15	
ATS35-C32-120-4T-09	●	35	25	17.5	120	18	32	CCMT09T308			
ATS40-C32-120-4T-09	●	40	32	20	120	18	32	CCMT09T308			
ATS50-C32-120-4T-12	●	50	32	25	120	22	39	CCMT120408	M5.0*11	T-20	

● Stock ○ Available upon Order

Turning inserts

External turning

Internal turning

Grooving & parting

Threading

Milling

Boring & drilling

Tool holder

Solid carbide end mills

Solid carbide drill & taps

Technical information

BUD

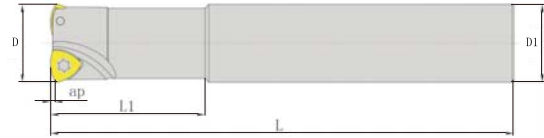

Ordering Code	Stock	Dimensions(mm)						Insert	Screw	Wrench
		D	D1	L	L1	ap	Z			
BUD08-20-2T20-120	○	20	20	120	40	1.0	2	UD**0803	M3*7	T-8
BUD08-20-2T20-160	○	20	20	160	50	1.0				
BUD08-20-2T20-200	○	20	20	200	60	1.0				
BUD08-25-2T25-120	○	25	25	120	40	1.0				
BUD08-25-2T25-160	○	25	25	160	50	1.0				
BUD08-25-2T25-200	○	25	25	200	60	1.0				
BUD12-25-2T25-160	○	25	25	160	50	1.5	3	UD**12T3	M4*10	T-15
BUD12-25-2T25-200	○	25	25	200	60	1.5				
BUD12-32-3T32-160	○	32	32	160	50	1.5				
BUD12-32-3T32-200	○	32	32	200	60	1.5				

BUD

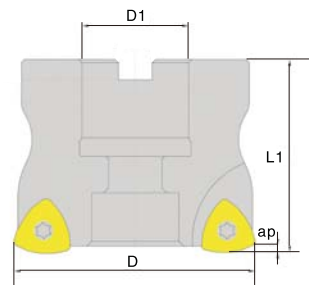

Ordering Code	Stock	Dimensions(mm)					Insert	Screw	Wrench
		D	D1	L1	ap	Z			
BUD12-050-4T-22	○	50	22	50	1.5	UD**12T3	M4*10	T-15	
BUD12-063-4T-22	○	63	22	50					
BUD12-080-5T-27	○	80	27	50					
BUD12-100-6T-32	○	100	32	50					

● Stock ○ Available upon Order

Turning inserts

External turning

Internal turning

Grooving & parting

Threading

Milling

Boring & drilling

Tool holder

Solid carbide end mills

Solid carbide drill & taps

Technical information

BAP Mills series

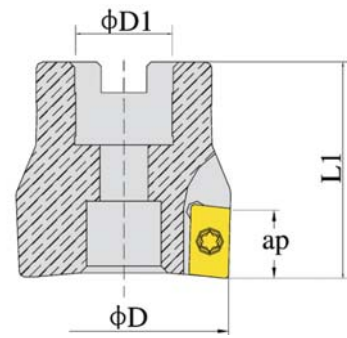

Ordering Code	Stock	Dimensions(mm)					Insert	Screw	Wrench
		D	D1	L1	ap	Z			
BAP400R 050 4T 22	●	50	22	50	16	4	AP**1604	M4*10	T-15
BAP400R 063 4T 22	●	63	22	50		4			
BAP400R 063 5T 22	●	63	22	50		5			
BAP400R 080 6T 27	●	80	27	50		6			
BAP400R 100 6T 32	●	100	32	50		6			
BAP400R 125 6T 40	●	125	40	63		6			
BAP400R 050 4T 25.4	○	50	25.4	50		4			
BAP400R 063 5T 25.4	○	63	25.4	50		5			
BAP400R 080 6T 25.4	○	80	25.4	50		6			
BAP400R 100 6T 31.75	○	100	31.75	50		6			

BRP Mills series

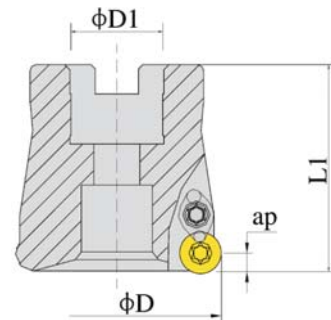

Ordering Code	Stock	Dimensions(mm)					Insert	Screw	Wrench	Clamp
		D	D1	L1	ap	Z				
BRP 5R 050 4T 22	●	50	22	50	5	4	RP**1003	M3,5*8	T-15	R5YD
BRP 5R 063 4T 22	●	63	22	50		4				
BRP 5R 063 5T 22	●	63	22	50		5				
BRP 5R 080 6T 27	●	80	27	50		6				
BRP 5R 100 6T 32	●	100	32	50		6				
BRP 6R 050 4T 22	●	50	22	50	6	4	RP**1204	M4.0*10	T-15	R6YD
BRP 6R 063 4T 22	●	63	22	50		4				
BRP 6R 080 6T 27	●	80	27	50		6				
BRP 6R 100 6T 32	●	100	32	50		6				

● Stock ○ Available upon Order

Turning inserts

External turning

Internal turning

Grooving & parting

Threading

Milling

Boring & drilling

Tool holder

Solid carbide end mills

Solid carbide drill & taps

Technical information

BRD Mills series

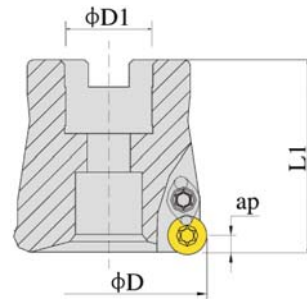

Ordering Code	Stock	Dimensions(mm)					Insert	Screw	Wrench	Clamp			
		D	D1	L1	ap	Z							
BRD 5R 050 4T 22	●	50	22	50	5	4	RD**10T3	M3.5*8	T-15	R5YD			
BRD 5R 063 4T 22	●	63	22	50		4							
BRD 5R 063 5T 22	●	63	22	50		5							
BRD 5R 080 6T 27	●	80	27	50		6							
BRD 5R 100 6T 32	●	100	32	50		6							
BRD 5R 125 7T 40	●	125	40	63		7							
BRD 5R 050 4T 25.4	○	50	25.4	50		4							
BRD 5R 063 4T 25.4	○	63	25.4	50		4							
BRD 5R 080 6T 25.4	○	80	25.4	50		6							
BRD 5R 100 6T 31.75	○	100	31.75	50		6							
BRD 5R 125 7T 38.1	○	125	38.1	63		7							
BRD 6R 050 4T 22	●	50	22	50	6	4	RD**1204	M4.0*10	T-15	R6YD			
BRD 6R 063 4T 22	●	63	22	50		4							
BRD 6R 063 5T 22	●	63	22	50		5							
BRD 6R 080 6T 27	●	80	27	50		6							
BRD 6R 100 6T 32	●	100	32	50		6							
BRD 6R 125 7T 40	●	125	40	63		7							
BRD 6R 050 4T 25.4	○	50	25.4	50		4							
BRD 6R 063 4T 25.4	○	63	25.4	50		4							
BRD 6R 080 6T 25.4	○	80	25.4	50		6							
BRD 6R 100 6T 31.75	○	100	31.75	50		6							
BRD 6R 125 7T 38.1	○	125	38.1	63		7							
BRD 8R 063 4T 22	●	63	22	50	8	4	RD**1604	M5.0*12	T-20	R6YD			
BRD 8R 080 5T 27	●	80	27	50		5							
BRD 8R 100 6T 32	●	100	32	50		6							
BRD 8R 125 7T 40	●	125	40	63		7							
BRD 8R 160 8T 40	●	160	40	63		8							
BRD 10R 100 6T 40	○	100	31.75	50	10	6				RD**2006			R10YD
BRD 10R 125 7T 40	○	125	38.1	63		7							
BRD 10R 160 8T 60	○	160	50.8	63		8							

● Stock ○ Available upon Order

BAN

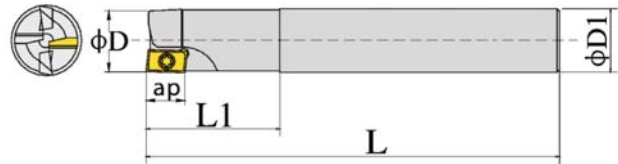

Ordering Code	Stock	Dimensions(mm)						Insert	Screw	Wrench			
		D	D1	L	L1	ap	Z						
BAN08-1616T2-125	●	16	16	125	26	8	AN**0804	AN09-M2.5	T-8				
BAN08-1616T2-160	○	16	16	160									
BAN08-2020T3-125	●	20	20	125									
BAN08-2020T3-160	○	20	20	160									
BAN08-2525T4-125	●	25	25	125									
BAN08-2525T4-160	○	25	25	160									
BAN08-3232T5-160	○	32	32	160									
BAN13-2525T2-125	●	25	25	125						13	AN**1305	AN13-M4.0	T-15
BAN13-2525T2-160	○	25	25	160									
BAN13-3232T3-160	●	32	32	160									
BAN13-3232T3-200	○	32	32	200									
BAN13-4040T4-160	○	40	40	160									
BAN13-4040T4-200	○	40	40	200									

BAN

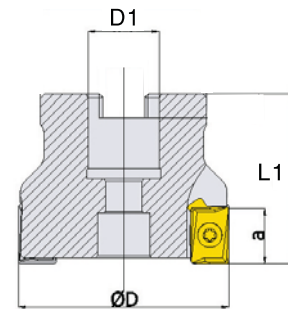

Ordering Code	Stock	Dimensions(mm)					Insert	Screw	Wrench
		D	D1	L1	ap	Z			
BAN16D050T4-22	●	50	22	50	16	AN**1606	AN16-M5.0	T-20	
BAN16D063T5-22	●	63	22	50					
BAN16D080T6-27	●	80	27	50					
BAN16D100T7-32	●	100	32	50					
BAN16D125T8-40	●	125	40	63					
BAN16D160T10-40	○	160	40	63					
BAN16D200T12-60	○	200	60	63					
BAN16D250T14-60	○	250	60	63					

● Stock ○ Available upon Order

Turning inserts

External turning

Internal turning

Grooving & parting

Threading

Milling

Boring & drilling

Tool holder





Solid carbide end mills

Solid carbide drill & taps

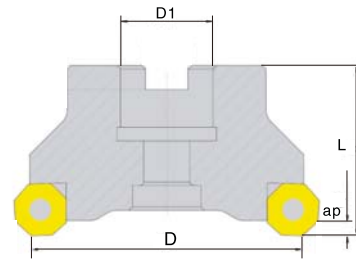
Technical information



SONFM

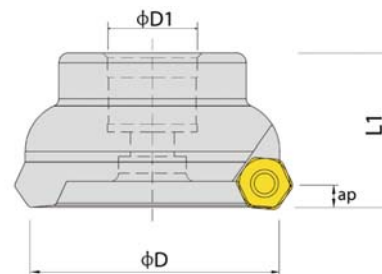

Ordering Code	Stock	Dimensions(mm)					Insert	Screw	Wrench
		D	D1	L	ap	Z			
SONFM45D050T04-22	●	50	22	50	3-6	4	  SN**1205 ON**1205	 SNON-M4.0	 T-15
SONFM45D063T05-22	●	63	22	50		5			
SONFM45D080T06-27	●	80	27	50		6			
SONFM45D100T07-32	●	100	32	50		7			
SONFM45D125T08-40	●	125	40	63		8			
SONFM45D160T10-40	●	160	40	63		10			
SONFM45D200T12-60	●	200	60	63		12			
SONFM45D250T14-60	●	250	60	63		14			
SONFM45D315T18-60	●	315	60	63	18				

TFM55° Facing mills series



Ordering Code	Stock	Dimensions(mm)					Insert	Screw	Wrench
		D	D1	L1	ap	Z			
TFM55AHNS 050 4T 22	●	50	22	50	4	 HN**0504	 M4.5*12	 T-20	
TFM55AHNS 063 5T 22	●	63	22	50					5
TFM55AHNS 080 6T 27	●	80	27	50					6
TFM55AHNS 100 7T 32	●	100	32	50					7
TFM55AHNS 125 8T 40	●	125	40	63					8
TFM55AHNS 160 9T 40	●	160	40	63					9

● Stock ○ Available upon Order

Turning inserts

External turning

Internal turning

Grooving & parting

Threading

Milling

Boring & drilling

Tool holder

Solid carbide end mills

Solid carbide drill & taps

Technical information

SE45° Facing mills series

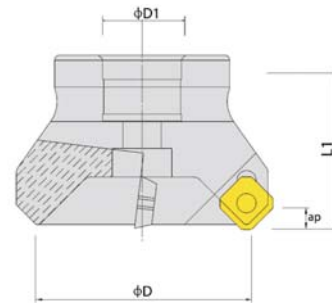

Ordering Code	Stock	Dimensions(mm)					Insert	Screw	Wrench
		D	D1	L1	ap	Z			
SE13 050 4T 22	●	50	22	50	5	4	SE**13T3	M3.5*8	T-15
SE13 063 5T 22	●	63	22	50		5			
SE13 080 5T 27	●	80	27	50		5			
SE13 100 6T 32	●	100	32	50		6			
SE13 125 7T 40	●	125	40	63		7			
SE13 160 8T 40	●	160	40	63		8			
SE13 200 10T 60	●	200	60	63		10			

BSE45° Straight shank facing mills series

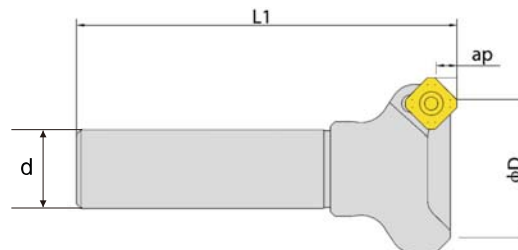

Ordering Code	Stock	Dimensions(mm)					Insert	Screw	Wrench
		D	d	L1	ap	Z			
BSE13 050 4T 120	●	50	32	120	6	4	SE**13T3	M3.5*8	T-15
BSE13 063 5T 120	●	63				5			
BSE13 080 5T 120	●	80				5			
BSE13 100 6T 120	●	100				6			

● Stock ○ Available upon Order

Turning inserts

External turning

Internal turning

Grooving & parting

Threading

Milling

Boring & drilling

Tool holder

Solid carbide end mills

Solid carbide drill & taps

Technical information

SE45° Facing mills series

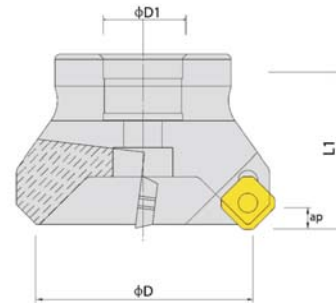

Ordering Code	Stock	Dimensions(mm)					Insert	Screw	Wrench
		D	D1	L1	ap	Z			
SE12 050 4T 22	●	50	22	50	5	4	SE**1204	M5.0*12	T-20
SE12 063 5T 22	●	63	22	50		5			
SE12 080 5T 27	●	80	27	50		5			
SE12 100 6T 32	●	100	32	50		6			
SE12 125 7T 40	●	125	40	63		7			
SE12 160 8T 40	●	160	40	63		8			
SE12 200 10T 60	●	200	60	63		10			

FM

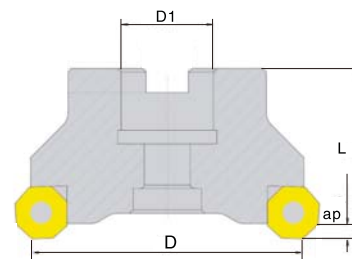

Ordering Code	Stock	Dimensions(mm)					Insert	Screw	Wrench
		D	D1	L	ap	Z			
FM45-D050T04-22-OD06	●	50	22	50	4	4	OD**0605	M5*12	T-20
FM45-D063T05-22-OD06	●	63	22	50		5			
FM45-D080T06-27-OD06	●	80	27	50		6			
FM45-D100T07-32-OD06	●	100	32	50		7			
FM45-D125T08-40-OD06	●	125	40	63		8			
FM45-D160T10-40-OD06	●	160	40	63		10			
FM45-D200T12-60-OD06	●	200	60	63		12			

● Stock ○ Available upon Order

Turning inserts

External turning

Internal turning

Grooving & parting

Threading

Milling

Boring & drilling

Tool holder

Solid carbide end mills

Solid carbide drill & taps

Technical information

BM90° Corn mills

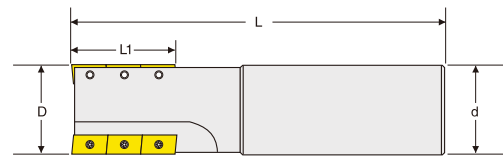

Ordering Code	Stock	Dimensions(mm)					Insert	Screw	Wrench
		D	d	L	L1	Z			
TAP11-20C20-28M-2T120	●	20	20	120	28	2	APMT1135	M2.5*6	T-18
TAP11-25C25-38M-2T130	●	25	25	130	38	2			
TAP11-25C25-48M-2T130	●	25	25	130	48	2			
TAP11-32C32-48M-3T140	●	32	32	140	48	3			
TAP16-32C32-70M-2T150	●	32	32	150	70	2	APMT1604	M4*10	T-15
TAP16-40C32-70M-2T150	●	40	32	150	70	2			
TAP16-40C32-70M-3T150	●	40	32	150	70	3			
TAP16-50C32-70M-3T150	●	50	32	150	70	3			

BM90° Corn mills

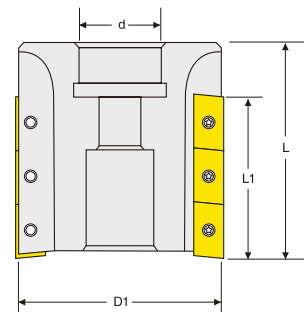

Ordering Code	Stock	Dimensions(mm)					Insert	Screw	Wrench
		D	d	L	L1	Z			
TAP16-D050-22-42M3T	●	50	22	120	42	3	APMT1604	M4*10	T-15
TAP16-D063-27-42M4T	●	63	27		42	4			
TAP16-D063-27-60M4T	●	63	27		60	4			
TAP16-D080-32-72M5T	●	80	32		72	5			

● Stock ○ Available upon Order

Turning inserts

External turning

Internal turning

Grooving & parting

Threading

Milling

Boring & drilling

Tool holder

Solid carbide end mills

Solid carbide drill & taps

Technical information

BT Corn mills

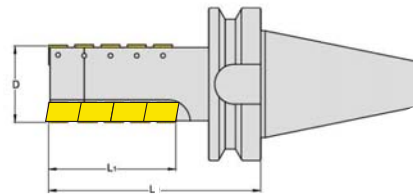

Ordering Code	Stock	Dimensions(mm)				Insert	Screw	Wrench
		D	L	L1	Z			
BT50-D50-70M4T-AP16	●	50		70	4	APMT1604	M4*10	T-15
BT50-D63-70M4T-AP16	●	63		70	4			
BT50-D63-85M4T-AP16	●	63		85	4			
BT50-D63-100M4T-AP16	●	63		100	5			
BT50-D80-99M5T-AP16	●	80		99	5			
BT50-D80-120M5T-AP16	●	80		120	5			
BT50-D100-118M6T-AP16	●	100		118	6			
BT50-D100-160M6T-AP16	●	100		160	6			
BT50-D100-280M6T-AP16	●	100		280	6			

HMC Corn mills

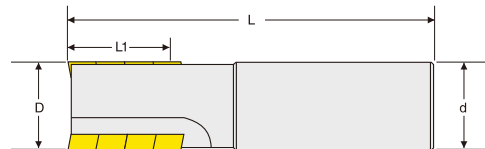

Ordering Code	Stock	Dimensions(mm)					Insert	Screw	Wrench
		D	d	L	L1	Z			
HMC90-025.029.2T25-CN07	●	25	25	106	29	2	CN**07	M3*12	T-9
HMC90-032.035.2T32-CN07	●	32	32	117	35	2			
HMC90-040.040.3T32-CN07	●	40	32	125	40	3			

● Stock ○ Available upon Order

Turning inserts

External turning

Internal turning

Grooving & parting

Threading

Milling

Boring & drilling

Tool holder

Solid carbide end mills

Solid carbide drill & taps

Technical information

HMC Corn mills

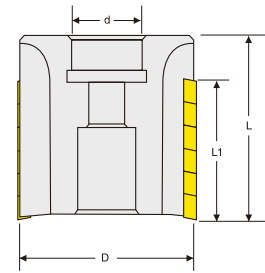

Ordering Code	Stock	Dimensions(mm)					Insert	Screw	Wrench
		D	d	L	L1	Z			
HMC90-050.052.4T22-CN07	●	50	22	70	52	4	CN**07	M3*12	T-9
HMC90-063.052.4T22-CN07	●	63	22		52	5			
HMC90-080.052.5T27-CN07	●	80	27		52	5			

TMR Side and face milling

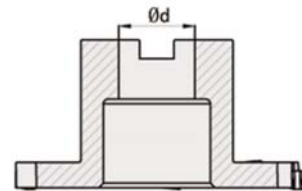
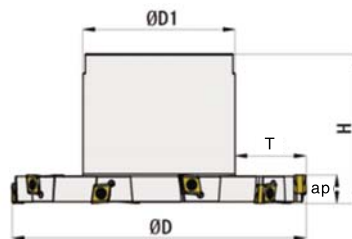

Ordering Code	Stock	Dimensions(mm)							Insert	Screw	Wrench
		D	d	L	ap	Z	T				
TMR-063.H10.05T22-CN07	●	63	22	50	10	5	10	CN**07	M3*12	T-9	
TMR-080.H10.06T27-CN07	●	80	27	50	10	6	14				
TMR-100.H10.08T32-CN07	●	100	32	50	10	8	19				
TMR-125.H10.10T32-CN07	●	125	32	63	10	10	29				
TMR-160.H10.12T40-CN07	●	160	40	63	10	12	43				
TMR-063.H12.05T22-CN07	●	63	22	50	12	5	10				
TMR-080.H12.06T27-CN07	●	80	27	50	12	6	14				
TMR-100.H12.08T32-CN07	●	100	32	50	12	8	19				
TMR-125.H12.10T32-CN07	●	125	32	63	12	10	29				
TMR-160.H12.12T40-CN07	●	160	40	63	12	12	43				

● Stock ○ Available upon Order

Turning inserts

External turning

Internal turning

Grooving & parting

Threading

Milling

Boring & drilling

Tool holder

Solid carbide end mills

Solid carbide drill & taps

Technical information

SMR Side and face mills

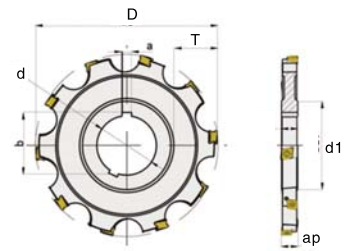

Ordering Code	Stock	Dimensions(mm)						Insert	Screw	Wrench
		D	d	d1	ap	Z	T			
SMR-063.H10.05T22-CN07	●	63	22	50	10	5	10	CN**07	M3*12	T-9
SMR-080.H10.06T27-CN07	●	80	27	50	10	6	14			
SMR-100.H10.08T32-CN07	●	100	32	50	10	8	19			
SMR-125.H10.10T32-CN07	●	125	32	63	10	10	29			
SMR-160.H10.12T40-CN07	●	160	40	63	10	12	43			
SMR-063.H12.05T22-CN07	●	63	22	50	12	5	10			
SMR-080.H12.06T27-CN07	●	80	27	50	12	6	14			
SMR-100.H12.08T32-CN07	●	100	32	50	12	8	19			
SMR-125.H12.10T32-CN07	●	125	32	63	12	10	29			
SMR-160.H12.12T40-CN07	●	160	40	63	12	12	43			

STF Slot mills

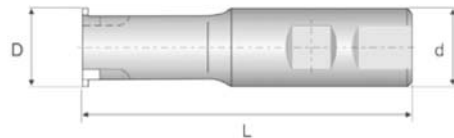

Ordering Code	Stock	Dimensions(mm)					Insert	Screw	Wrench
		D	d	L	T	Z			
STF-2520.1T.GBA32-100L	●	20	16	100	0.8-2.0	1	GBA32**	M3.5*8	T-15
STF-3225.2T.GBA32-120L	●	25	20	120		2			
STF-4032.3T.GBA32-150L	●	32	25	150		3			

STF Solt mills

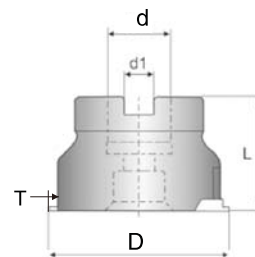

Ordering Code	Stock	Dimensions(mm)					Insert	Screw	Wrench
		D	d	H	T	Z			
STF-054.22.4T.GBA32	●	54	22	40	0.8-2.0	4	GBA32**	M3.5*8	T-15
STF-063.22.5T.GBA32	●	63	22	40		5			
STF-080.27.6T.GBA32	●	80	27	50		6			
STF-100.32.8T.GBA33	●	100	32	50		8			

● Stock ○ Available upon Order

Turning inserts

External turning

Internal turning

Grooving & parting

Threading

Milling

Boring & drilling

Tool holder

Solid carbide end mills

Solid carbide drill & taps

Technical information

BBMS Mills

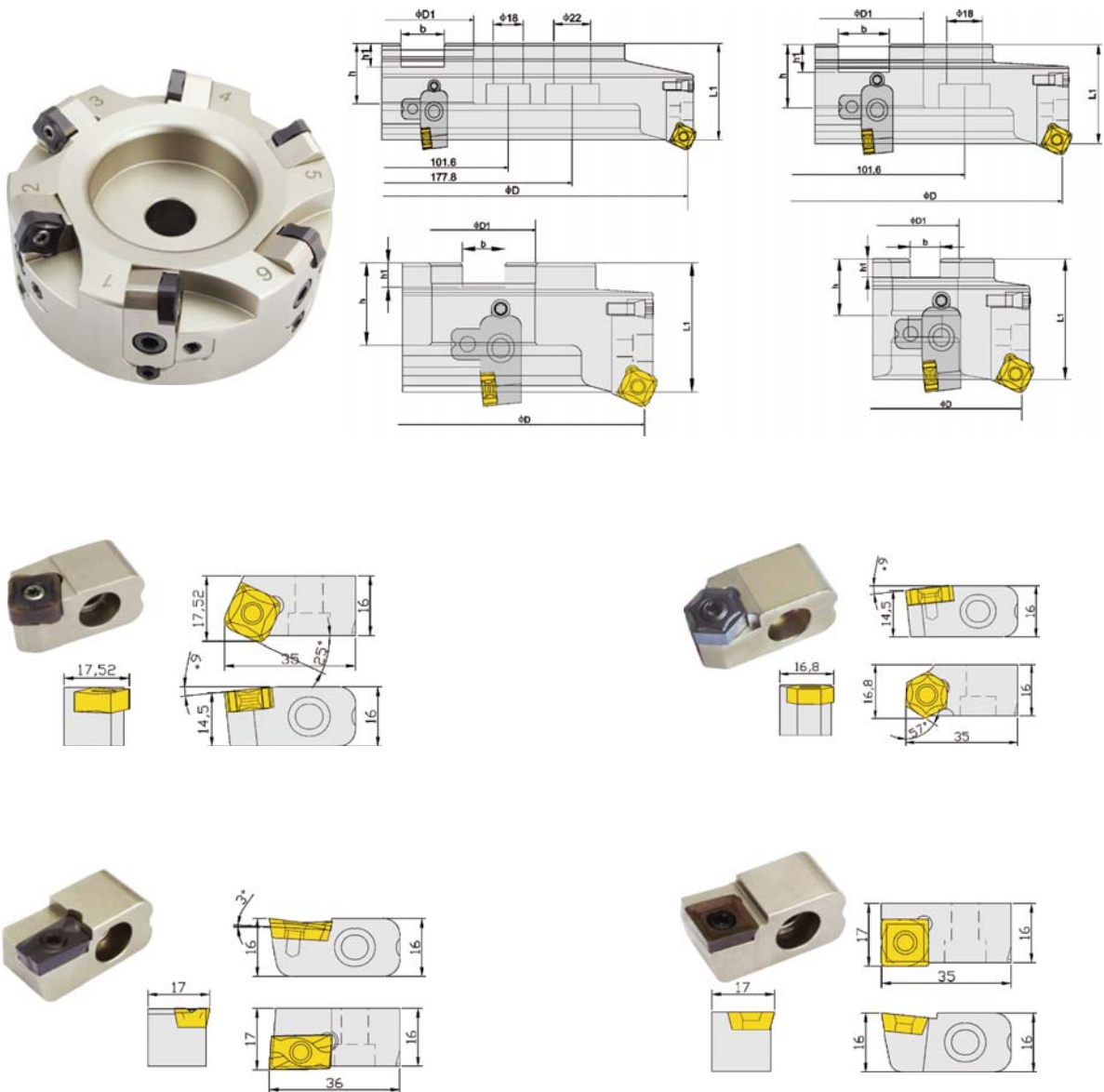

Ordering Code	Stock	Dimensions(mm)				Holder	Clamp	Insert	Screw	Wrench	Screw	Screw
		D	D1	L	Z							
BBMS.DP063.22.04T	●	63	22	50	4	DJ-SNMT	BYB1210	SNMT1205	M4*10	 L1.5 L3.0 L5.0 T-15	TJLS0510	DGD0620 ST0625
BBMS.DP080.27.05T	●	80	27	50	5							
BBMS.DP100.32.06T	●	100	32	50	6							
BBMS.DP125.40.08T	●	125	40	50	8							
BBMS.DP160.40.10T	●	160	40	50	10							
BBMS.DP200.60.12T	●	200	60	50	12							
BBMS.DP250.60.14T	●	250	60	50	14							
BBMS.DP315.60.16T	●	315	60	58	16							

● Stock ○ Available upon Order

Turning inserts

External turning

Internal turning

Grooving & parting

Threading

Milling

Boring & drilling

Tool holder

Solid carbide end mills

Solid carbide drill & taps

Technical information